



an ISO 9001:2008 Registered Company

1968 CHEVY NOVA

CONDENSER WITH DRIER

021165

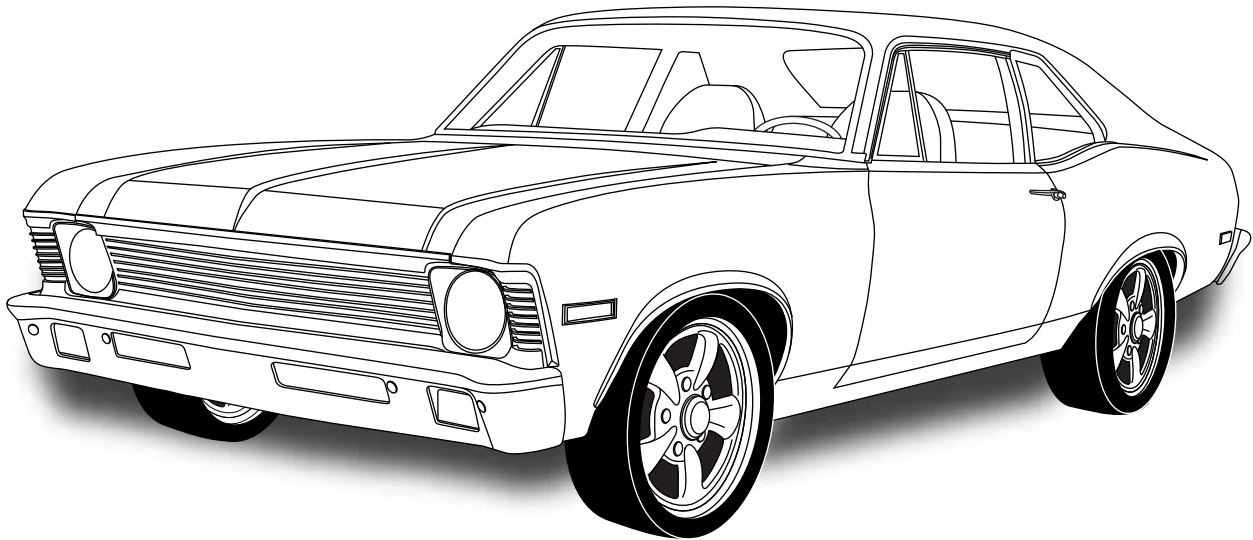

18865 GOLL ST. - SAN ANTONIO, TX. - 78266 ph.210-654-7171 - fax 210-654-3113



TABLE OF CONTENTS

PAGES

1. COVER
2. TABLE OF CONTENTS
3. PACKING LIST/PARTS DISCLAIMER
4. INFORMATION PAGE
5. MOUNTING BRACKET INSTALLATION
6. RADIATOR/HOOD LATCH REMOVAL & CONDENSER INSTALLATION
7. CONDENSER INSTALLATION CONT. & HOOD LATCH INSTALLATION
8. DRIER/SAFETY SWITCH & HARDLINE INSTALLATION
9. HARDLINE INSTALLATION CONT.
10. PACKING LIST



**CONDENSER KIT
021165**

No.	QTY.	PART No.	DESCRIPTION
1.	1	03767-VUC	14 X 24 PARALLEL FLOW COND.
2.	2	07113-VUB	DRIER CLAMP
3.	1	07321-VUC	DRIER
4.	7	18249-VUB	10-24 X 3/8 PAN HEAD SCREW
5.	7	18260-VUB	10-24 NUT W/STAR WASHER
6.	1	18266-VUB	#14 X 3/4 SHEETMETAL SCREW
7.	2	18290-VUB	1/4-20 X 1 HEX BOLT
8.	3	18125-VUB	1/4 FLAT WASHER
9.	2	18152-VUB	1/4-20 NUT W/STAR WASHER
10.	2	33857-VUF	#6 O-RING
11.	1	33858-VUF	#8 O-RING
12.	1	091163	HARDLINE 68-72 NOVA PS #8 COND/COMP
13.	1	091164	HARDLINE 68-72 NOVA #6 DRIER/COND
14.	1	643055	BRACKET 68-72 NOVA TOP CONDENSER
15.	1	643056	BRACKET 68-72 NOVA BOTTOM CONDENSER
16.	1	11079-VUS	MALE BINARY SWITCH
17.	1	23127-VUW	72" COMPRESSOR LEAD
18.	1	31603-VUD	#4 ADEL CLAMP
19.	1	31600-VUD	#2 ADEL CLAMP
20.	1	18250-VUB	10-32 X 1/2 PHPS SCREW
21.	1	18251-VUB	10-32 NUT W/STAR WASHER

****BEFORE BEGINNING INSTALLATION OPEN ALL PACKAGES AND CHECK CONTENTS OF SHIPMENT PLEASE REPORT ANY SHORTAGES DIRECTLY TO VINTAGE AIR WITHIN 15 DAYS. AFTER 15 DAYS, VINTAGE AIR WILL NOT BE RESPONSIBLE FOR MISSING OR DAMAGED ITEMS.**

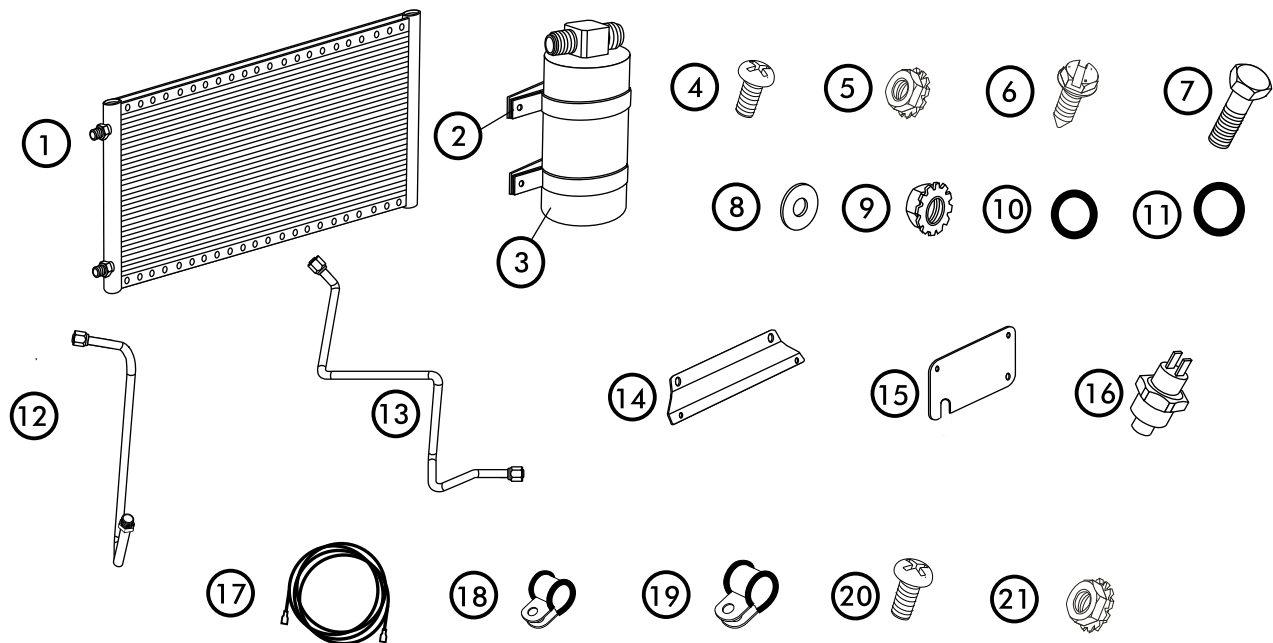

NOTE: IMAGES MAY NOT DEPICT ACTUAL PARTS AND QUANTITIES. REFER TO PACKING LIST FOR ACTUAL PARTS AND QUANTITIES



1968 NOVA

IMPORTANT NOTICE-PLEASE READ

THIS KIT WAS DEVELOPED BASED ON THE MEASUREMENTS BELOW, WHICH WERE TAKEN FROM A 1968 NOVA w/ FACTORY AIR CORE SUPPORT.

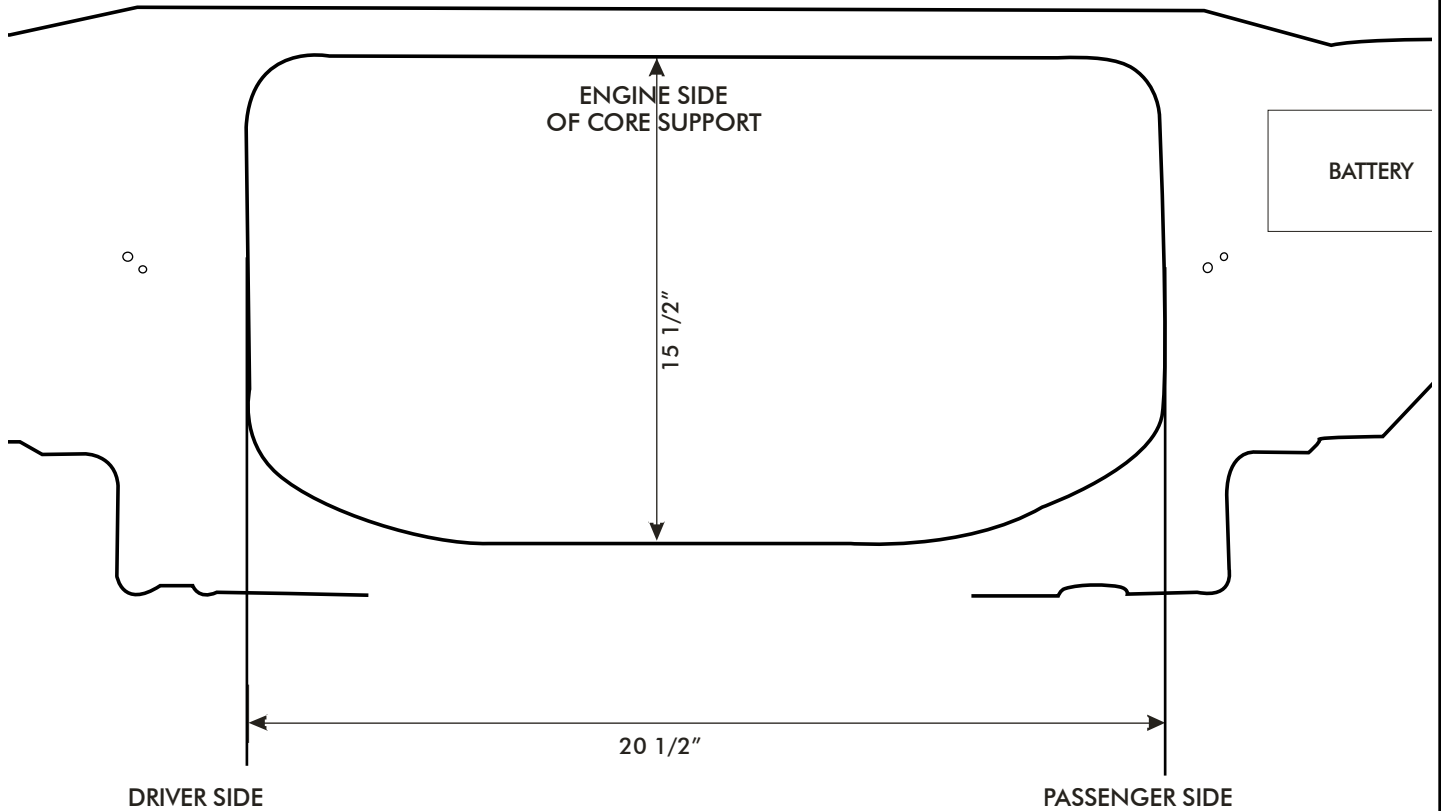



MOUNTING BRACKET INSTALLATION

- INSTALL TOP MOUNTING BRACKET ON TO CONDENSER USING (4) 10-24 X 3/8 PAN HEAD SCREWS AND (4) 10-24NUTS WITH STAR WASHERS. **NOTE BRACKET MOUNTS THROUGH THE 6TH & 13TH HOLE FROM THE LEFT SIDE OF THE CONDENSER.**

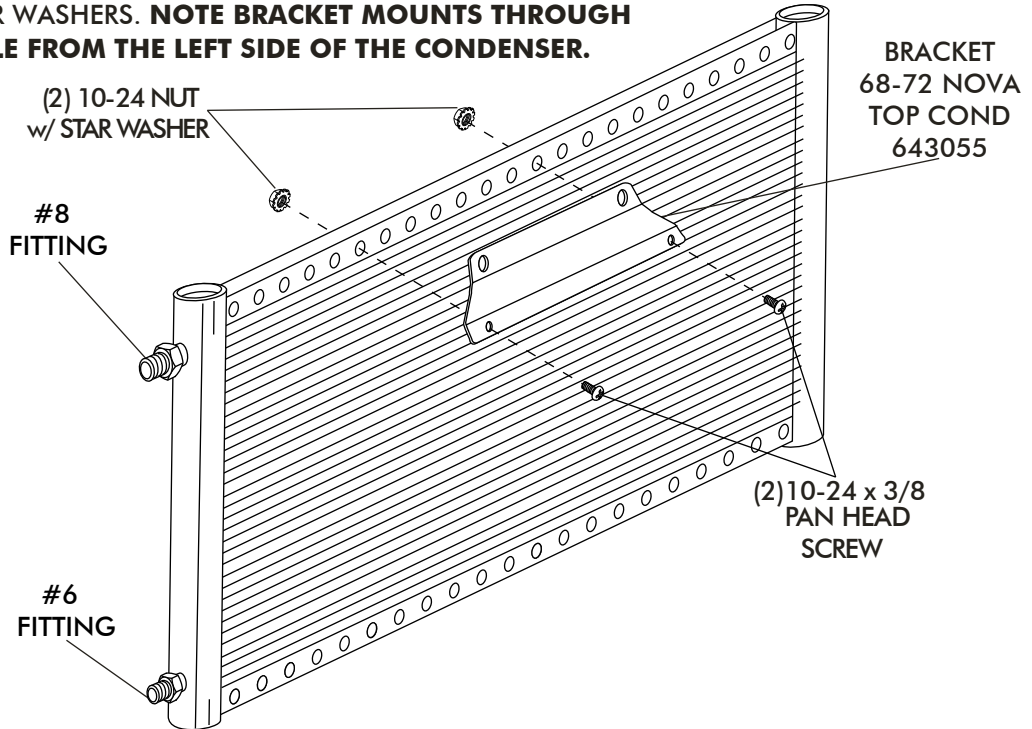

- INSTALL BOTTOM MOUNTING BRACKET ON TO CONDENSER USING (2) 10-24 X 3/8 PAN HEAD SCREWS AND (2) 10-24 NUTS WITH STAR WASHERS. **NOTE BRACKET MOUNTS THROUGH THE 7TH & 11TH HOLE FROM THE LEFT SIDE OF THE CONDENSER (BACK VIEW).**

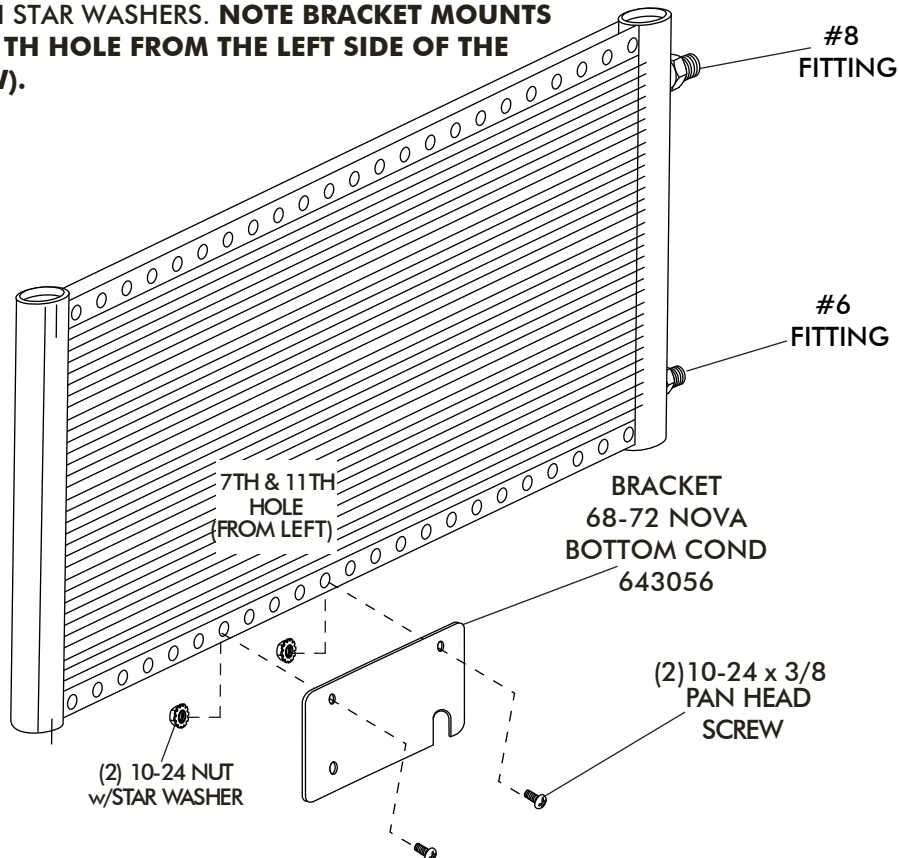



RADIATOR REMOVAL

- DRAIN RADIATOR, REMOVE UPPER AND LOWER RADIATOR HOSES AND REMOVE RADIATOR.

HOOD LATCH ASSEMBLY

- REMOVE OEM HOOD LATCH ASSEMBLY

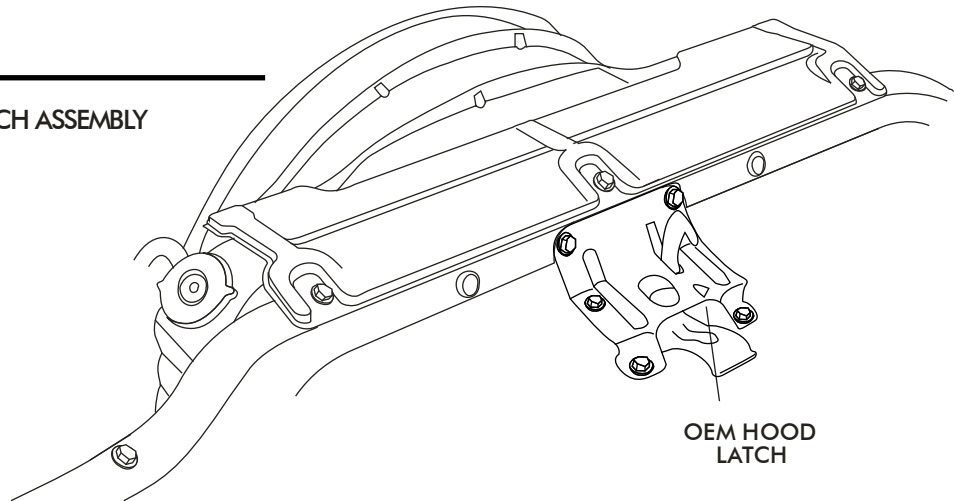

CONDENSER INSTALLATION

- INSTALL CONDENSER AS SHOWN BELOW.

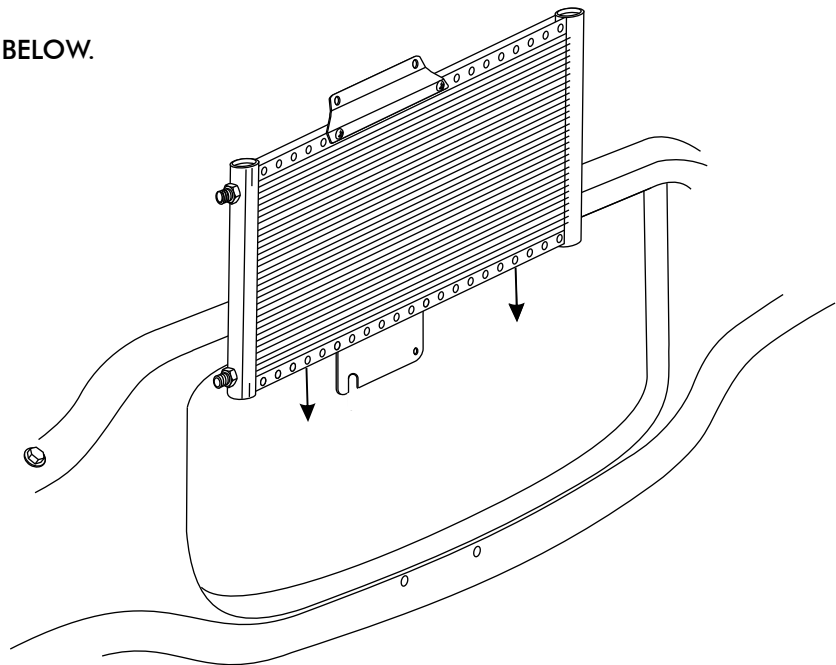



CONDENSER INSTALLATION CONT.

- SECURE THE BOTTOM PASSENGER SIDE OF THE CONDENSER TO THE CORE SUPPORT USING OEM BOLT.
- USE DRIVER SIDE MOUNTING HOLE AS GUIDE DRILL 3/16" HOLE ON CORE SUPPORT. SECURE CONDENSER TO CORE SUPPORT USING #14 X 3/4 SHEETMETAL SCREW W/FLAT WASHERS.

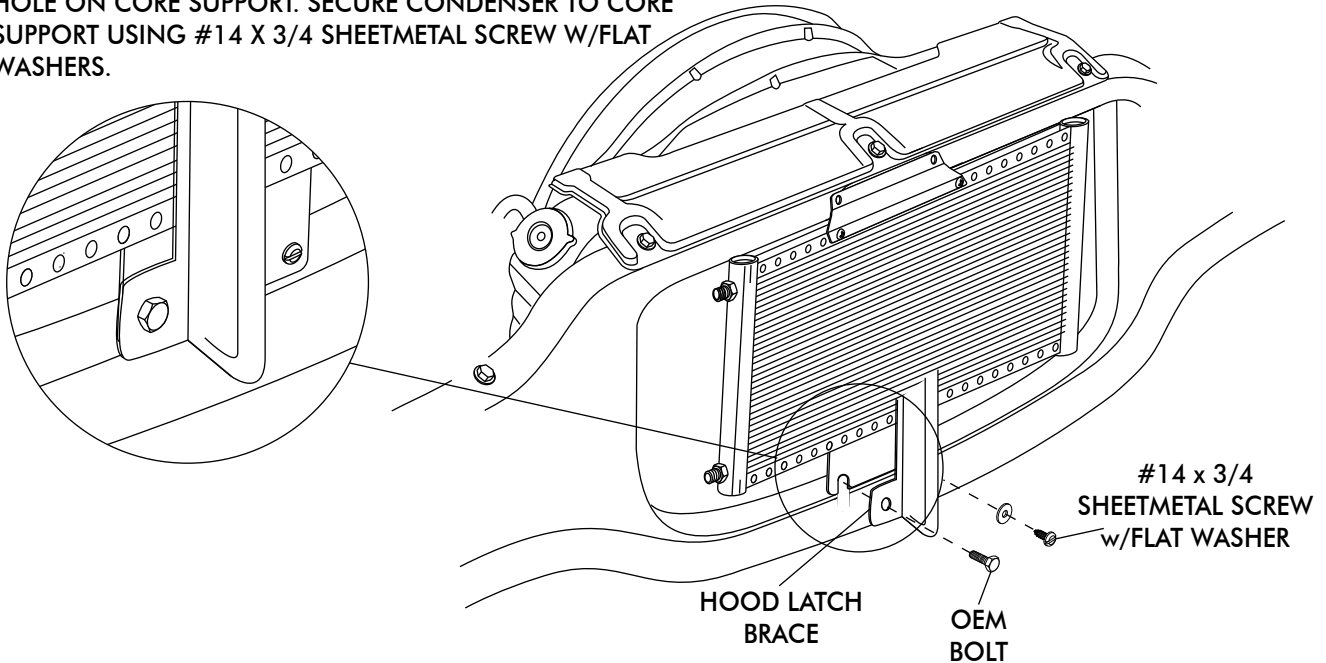

HOOD LATCH INSTALLATION

- RE-INSTALL HOOD LATCH ASSEMBLY USING OEM BOLTS, INSTALL OEM BOLTS THROUGH THE HOOD LATCH ASSEMBLY, CONDENSER, BRACKET, AND THROUGH THE CORE SUPPORT.

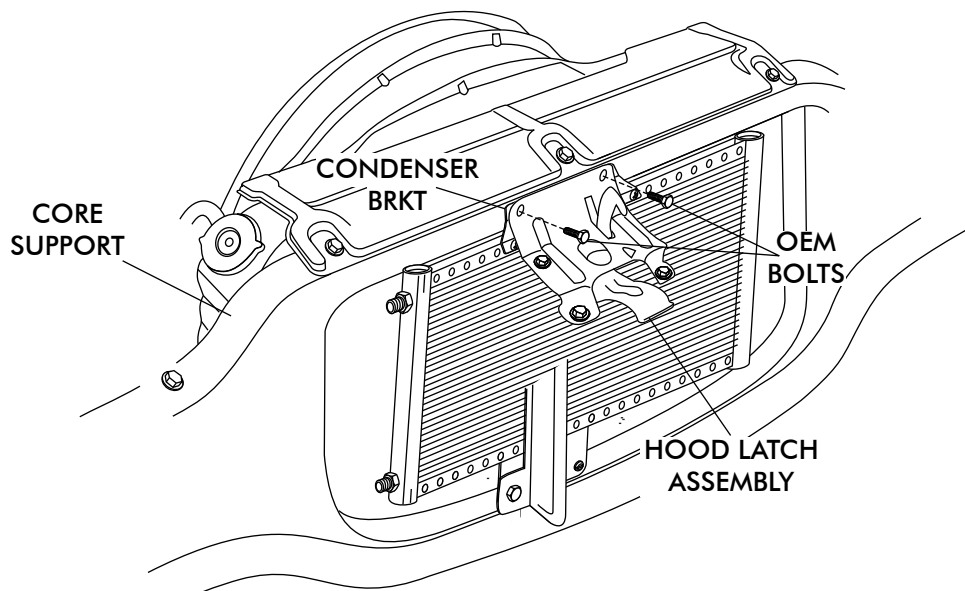



DRIER/SAFETY SWITCH INSTALLATION

- MOUNT DRIER ON PASSENGER SIDE INNER FENDERWELL.
- INSTALL DRIER/DRIER CLAMP TO INNER FENDERWELL USING (2) 1/4-20 X 1" BOLT W/FLAT WASHERS ON BOTTOM SIDE OF INNER FENDERWELL AND 1/4-20 HEX NUT W/STARWASHER.
- NOTE: REFRIGERANT FLOW THROUGH DRIER IS IN FROM CONDENSER, OUT TO EVAPORATOR.**
- NOTE: W/AC CARS USE OEM HOLE. WO/AC CARS USE OEM DIMPLE AS A GUIDE AND DRILL 9/32 HOLE. BE SURE TO CHECK FLOW ARROW OF DRIER.**

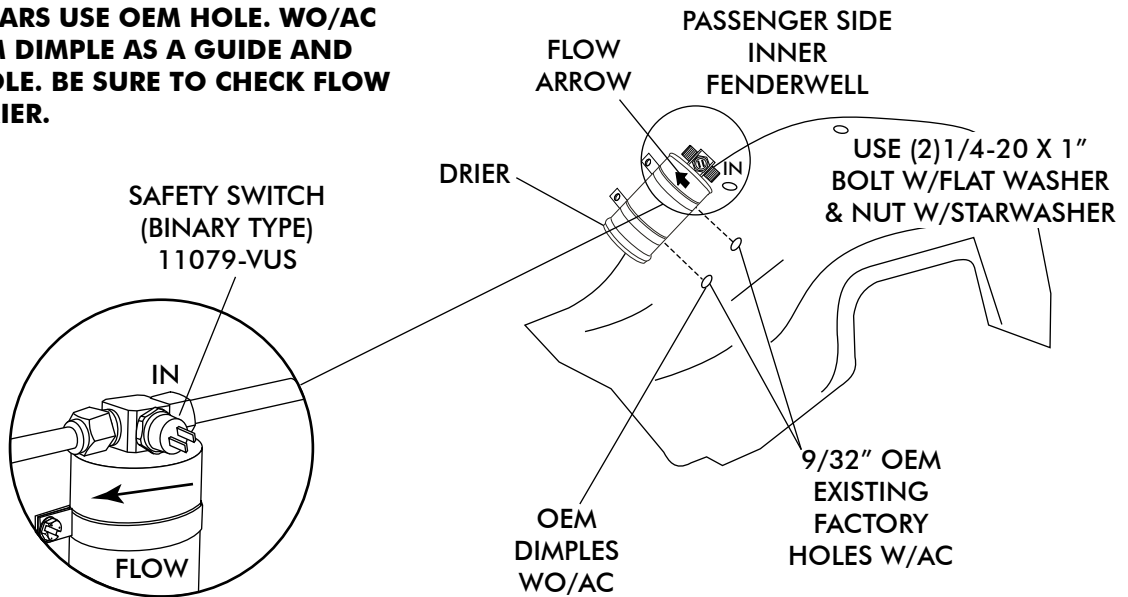

HARDLINE INSTALLATION

- LUBRICATE (2) #6 O-RING (SEE FIGURE 1, PAGE 9) AND INSTALL THE #6 DRIER/COND HARDLINE AS SHOWN.

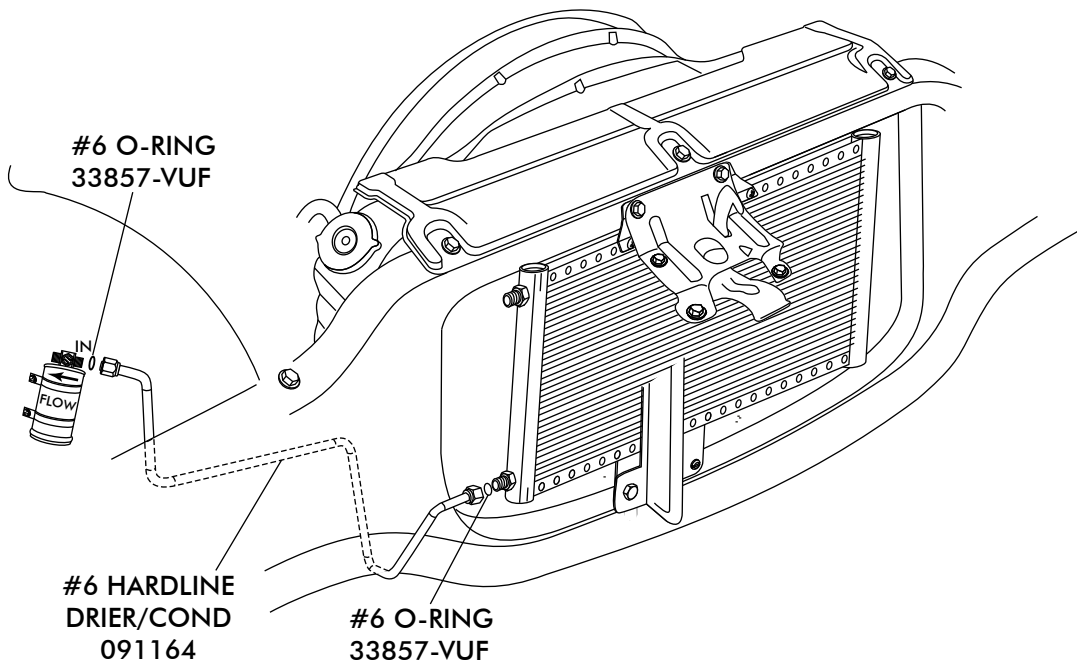



HARDLINE INSTALLATION CONT.

- LUBRICATE A #8 O-RING (SEE FIGURE 1, BELOW) AND INSTALL THE #8 CONDENSER/COMPRESSOR HARDLINE AS SHOWN IN BELOW. TIGHTEN FITTINGS AS SHOWN IN FIGURE 1, BELOW.
- SECURE #8 LINE TO #6 LINE USING ADEL CLAMPS AND 10-32 SCREW AND NUT W/STARWASHER AS SHOWN BELOW.

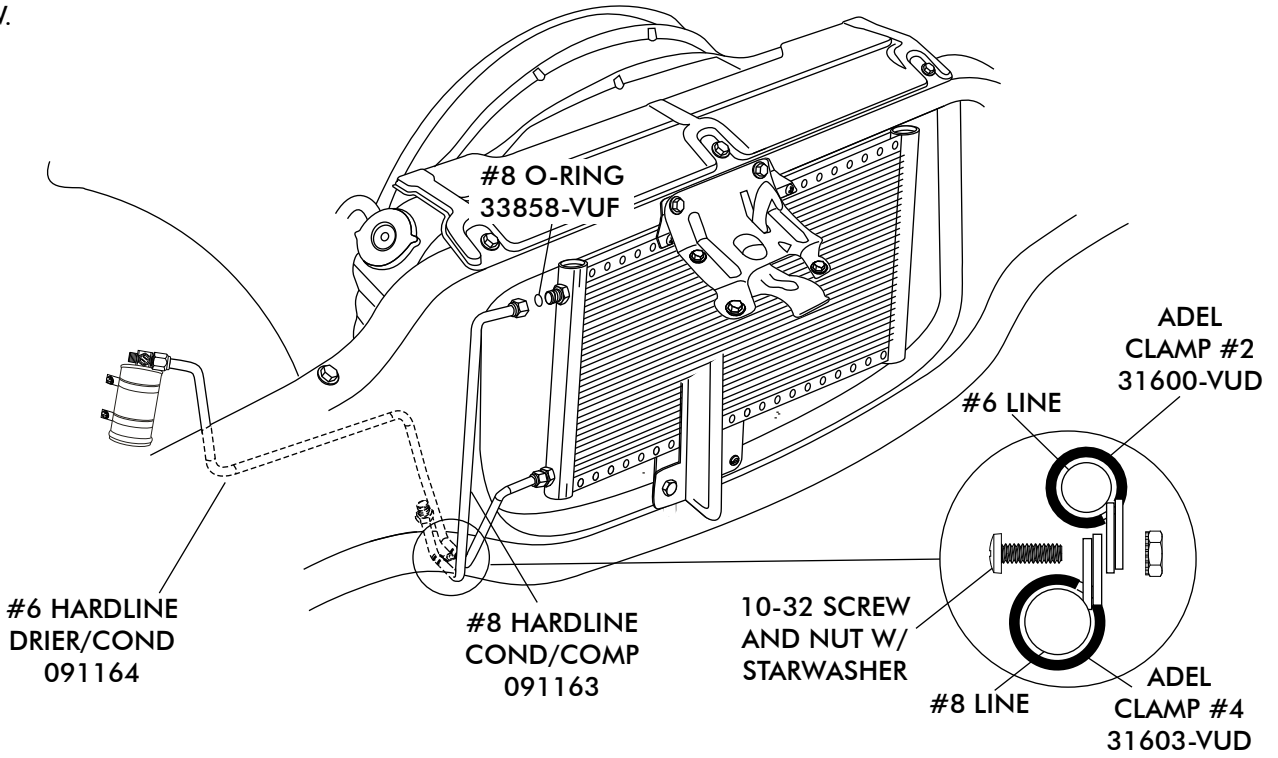

FOR A PROPER SEAL OF FITTINGS:
 INSTALL SUPPLIED O-RINGS AS SHOWN AND LUBRICATE WITH SUPPLIED OIL.

FIGURE 1



**CONDENSER KIT
021165**

No.	QTY.	PART No.	DESCRIPTION
1.	1	03767-VUC	14 X 24 PARALLEL FLOW COND.
2.	2	07113-VUB	DRIER CLAMP
3.	1	07321-VUC	DRIER
4.	7	18249-VUB	10-24 X 3/8 PAN HEAD SCREW
5.	7	18260-VUB	10-24 NUT W/STAR WASHER
6.	1	18266-VUB	#14 X 3/4 SHEETMETAL SCREW
7.	2	18290-VUB	1/4-20 X 1 HEX BOLT
8.	3	18125-VUB	1/4 FLAT WASHER
9.	2	18152-VUB	1/4-20 NUT W/STAR WASHER
10.	2	33857-VUF	#6 O-RING
11.	1	33858-VUF	#8 O-RING
12.	1	091163	HARDLINE 68-72 NOVA PS #8 COND/COMP
13.	1	091164	HARDLINE 68-72 NOVA #6 DRIER/COND
14.	1	643055	BRACKET 68-72 NOVA TOP CONDENSER
15.	1	643056	BRACKET 68-72 NOVA BOTTOM CONDENSER
16.	1	11079-VUS	MALE BINARY SWITCH
17.	1	23127-VUW	72" COMPRESSOR LEAD
18.	1	31603-VUD	#4 ADEL CLAMP
19.	1	31600-VUD	#2 ADEL CLAMP
20.	1	18250-VUB	10-32 X 1/2 PHPS SCREW
21.	1	18251-VUB	10-32 NUT W/STAR WASHER

CHECKED BY: _____
 PACKED BY: _____
 DATE: _____

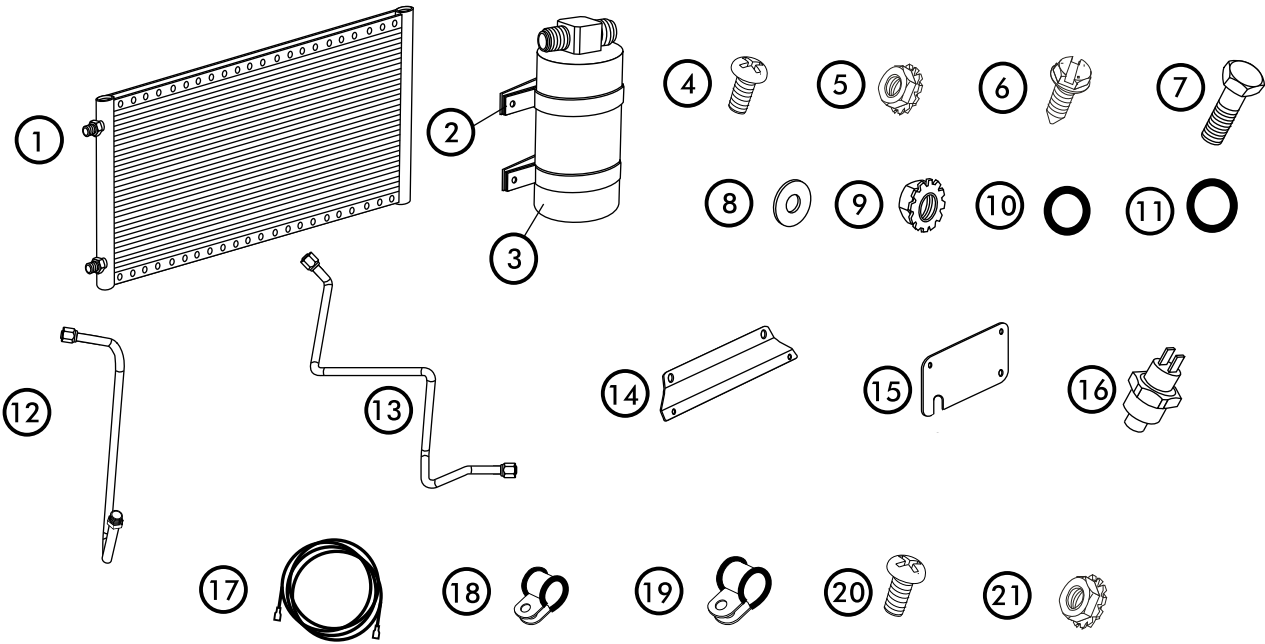

**NOTE: IMAGES MAY NOT DEPICT ACTUAL PARTS AND QUANTITIES.
 REFER TO PACKING LIST FOR ACTUAL PARTS AND QUANTITIES**