



an ISO 9001:2008 Registered Company

1960-66 CHEV PICK-UP

CONDENSER WITH DRIER

021564

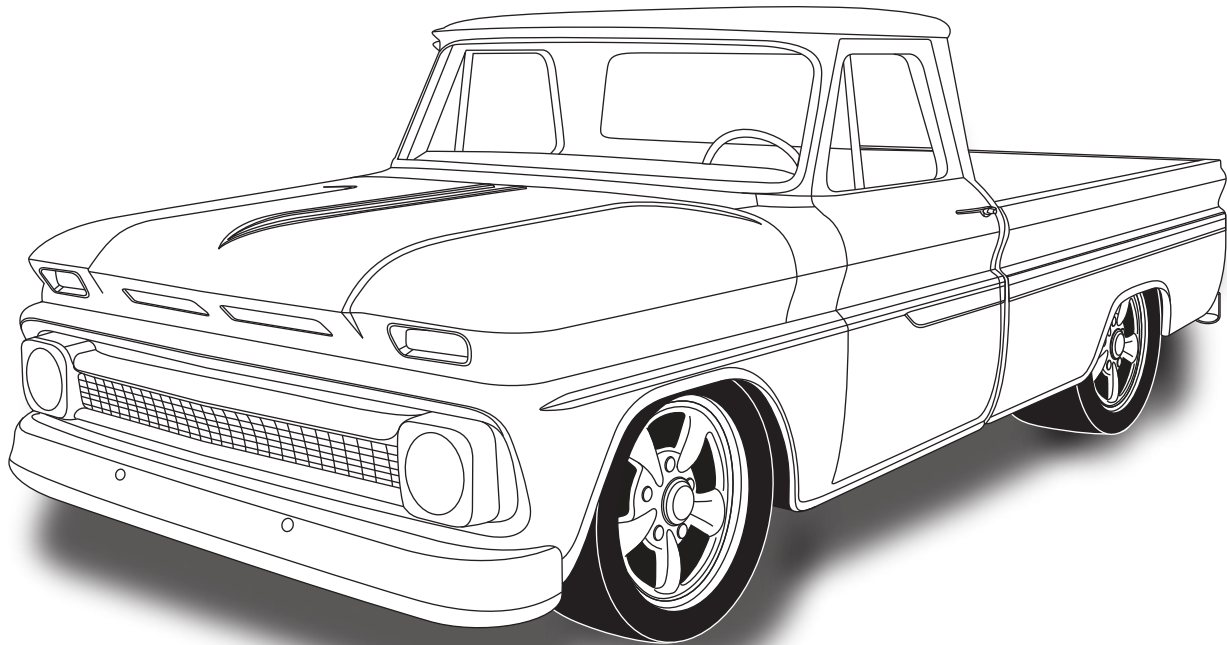

18865 GOLL ST. - SAN ANTONIO, TX. - 78266 ph.210-654-7171 - fax 210-654-3113



TABLE OF CONTENTS

PAGES

1. COVER
2. TABLE OF CONTENTS
3. PACKING LIST/PARTS DISCLAIMER
4. CORE SUPPORT MODIFICATION
5. CONDENSER MOUNTING BRACKET & DRIER BRACKET INSTALLATION
6. DRIER & HARDLINE INSTALLATION
FIGURE 1
7. CONDENSER INSTALLATION & HARDLINE & BINARY SWITCH INSTALLATION
8. HARDLINE ADEL CLAMP INSTALLATION
9. PACKING LIST



**CONDENSER KIT
021564**

1960-66 CHEV PICK-UP CONDENSER WITH DRIER

No.	QTY.	PART No.	DESCRIPTION
1.	1	03768-VUC	17" X 19" SUPER FLOW COND
2.	2	07113-VUB	DRIER CLAMP
3.	1	07321-VUC	DRIER
4.	2	18247-VUB	#10 x 1/2" HEX SCREW
5.	12	18249-VUB	10-24 X 3/8" PAN HEAD SCREW
6.	12	18260-VUB	10-24 NUT W/STAR WASHER
7.	1	33134-VUI	2 HOLE GROMMET
8.	3	33857-VUF	#6 O-RING
9.	1	33858-VUF	#8 O-RING
10.	1	095015	HARDLINE 60-66 CHEV P-UP #6 COND/DRIER
11.	1	095013	HARDLINE 60-66 CHEV P-UP #6 DRIER/CORE
12.	1	095014	HARDLINE 60-66 CHEV P-UP #8 COND/COMP
13.	2	644091	BRKT 55-66 CHEV P-UP COND
14.	1	644090	BRKT 55-66 CHEV P-UP DRIER
15.	1	31600-VUD	#2 ADEL CLAMP
16.	1	31603-VUD	#4 ADEL CLAMP
17.	1	11079-VUS	MALE BINARY SWITCH
18.	1	23135-VUW	COMPRESSOR LEAD
19.	1	18256-VUB	10-32 x 3/4 PAN HEAD SCREW
20.	1	49705-VUI	NYLON FLAT WASHER 1/8
21.	1	18251-VUB	10-32 NUT w/ STAR WASHER

BEFORE BEGINNING INSTALLATION OPEN ALL PACKAGES AND CHECK CONTENTS OF SHIPMENT PLEASE REPORT ANY SHORTAGES DIRECTLY TO VINTAGE AIR WITHIN 15 DAYS. AFTER 15 DAYS, VINTAGE AIR WILL NOT BE RESPONSIBLE FOR MISSING OR DAMAGED ITEMS.

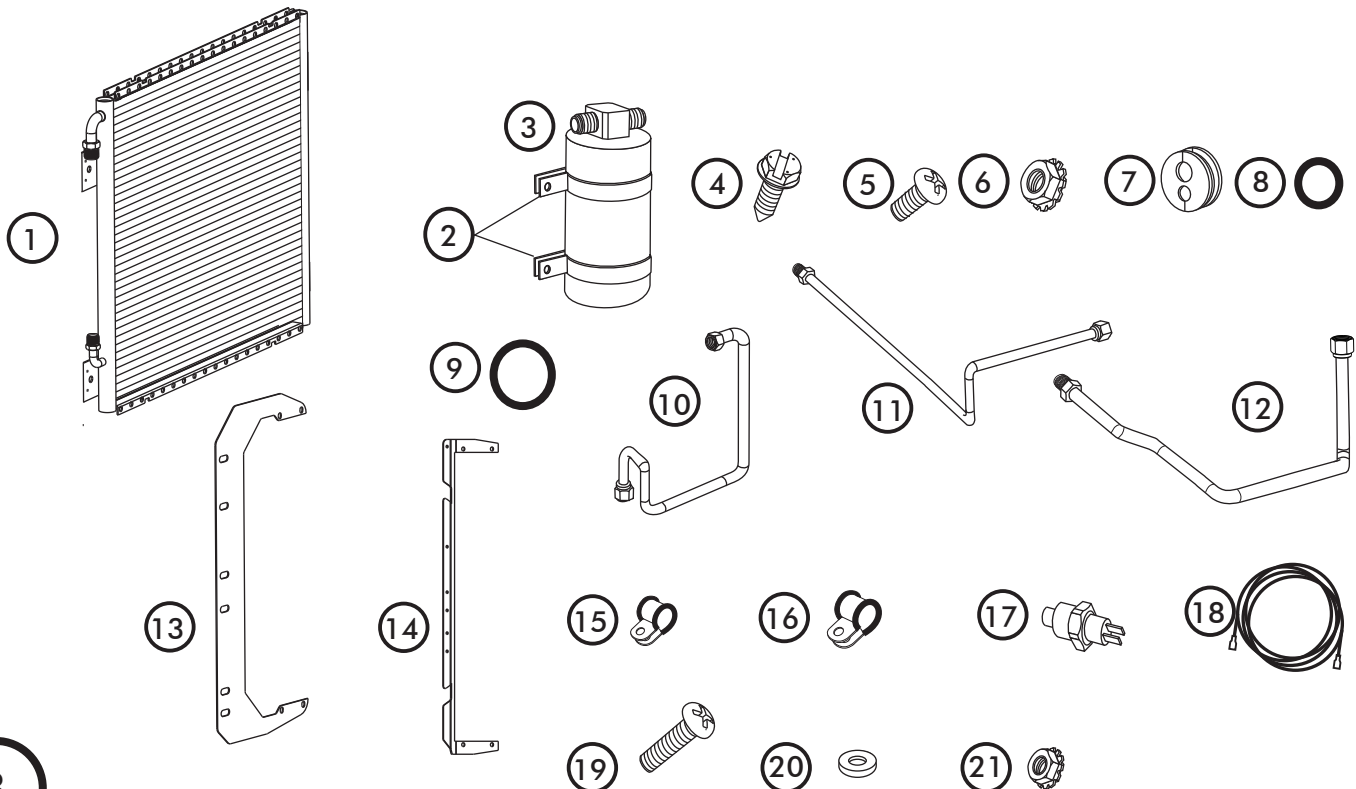



- REMOVE OEM RADIATOR, BATTERY TRAY, AND PASSENGER SIDE BAFFLE. (RETAIN)

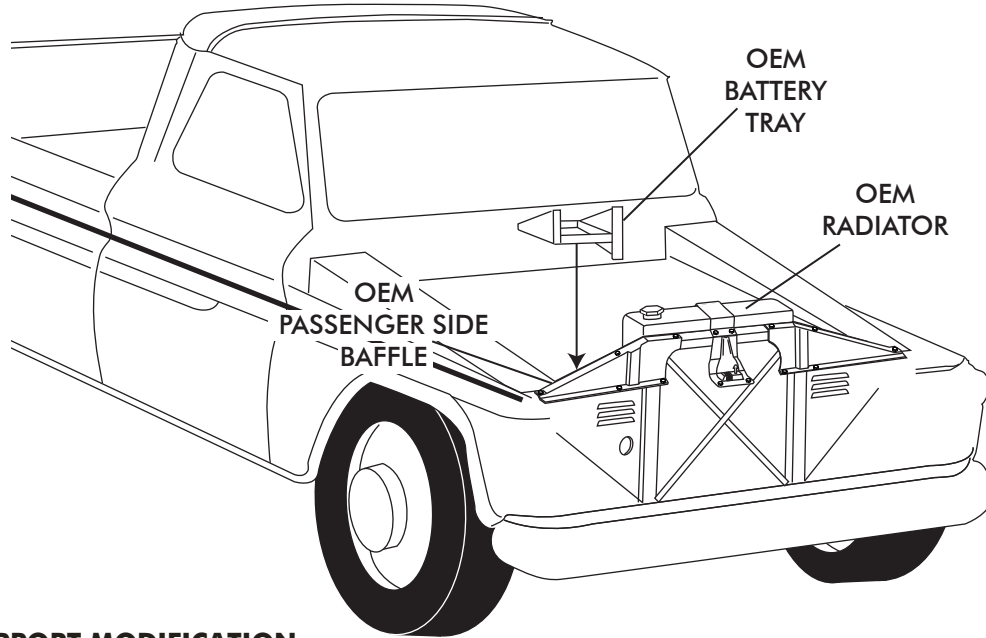

CORE SUPPORT MODIFICATION

- DRILL 1 1/4" HOLE THROUGH CORE SUPPORT AS SHOWN.
- INSTALL 2-HOLE GROMMET.

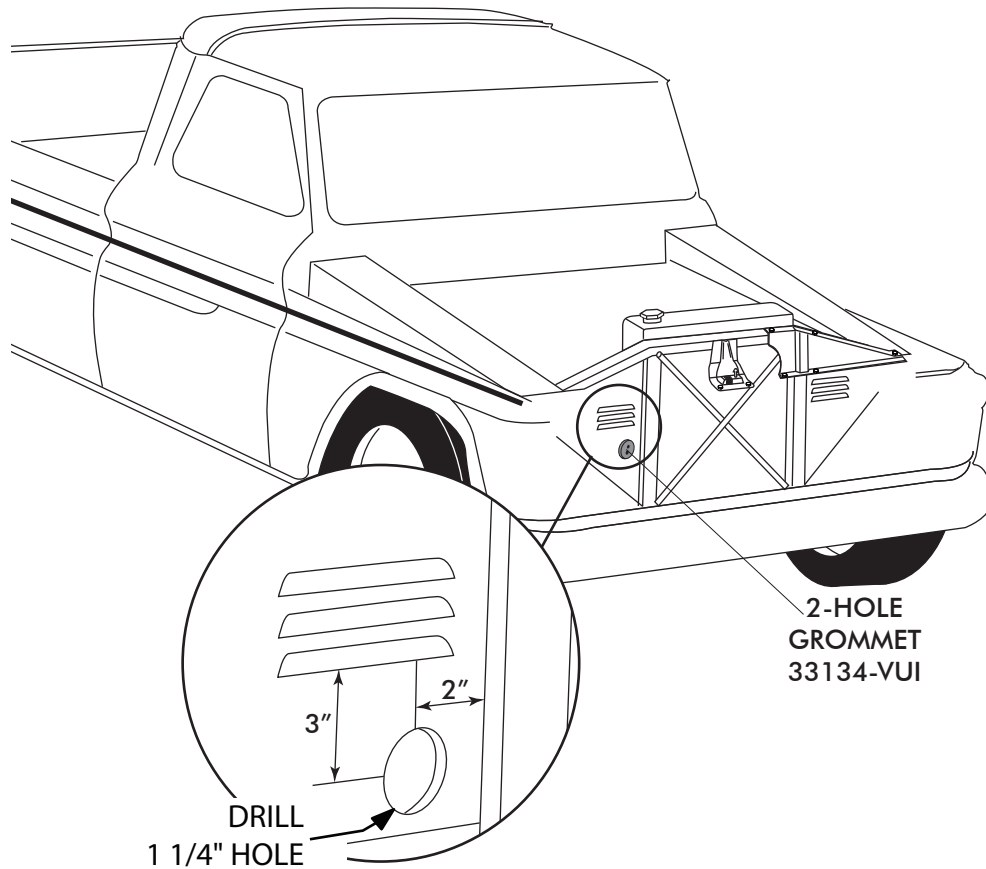



CONDENSER MOUNTING BRACKET & DRIER BRACKET INSTALLATION

- INSTALL CONDENSER MOUNTING BRACKETS ON TO BACK OF CONDENSER USING 10-24 X 3/8" PAN HEAD SCREWS AND 10-24 NUTS WITH STAR WASHERS.

NOTE BRACKET MOUNTS THROUGH THE 2ND & 4TH HOLES OF CONDENSER.

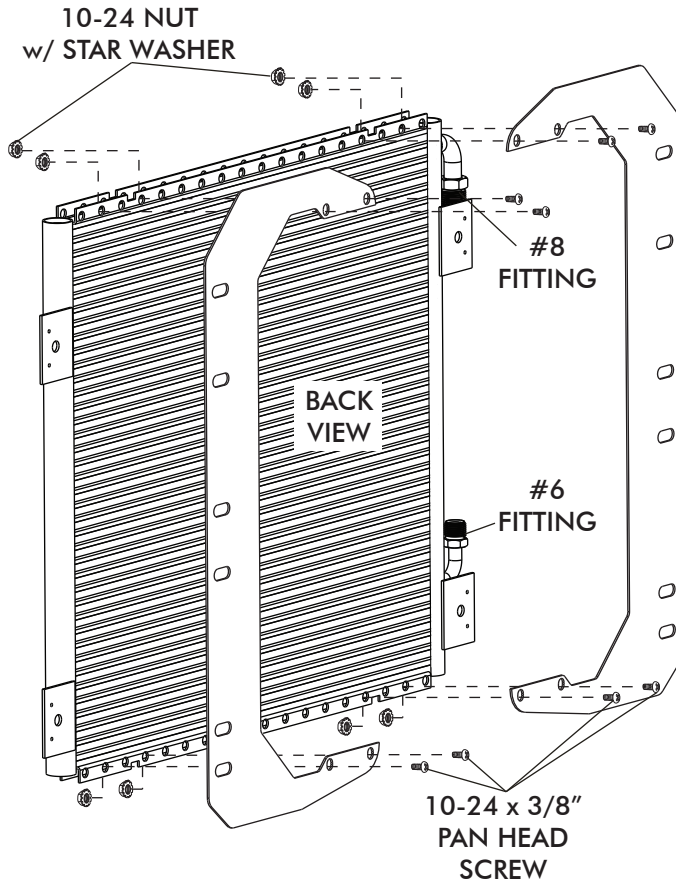

- INSTALL UNIVERSAL DRIER BRACKET ON TO CONDENSER USING 10-24 X 3/8" PAN HEAD SCREWS AND 10-24 NUTS WITH STAR WASHERS. **NOTE: BRACKET MOUNTS THROUGH 1ST AND 3RD HOLES OF THE CONDENSER.**

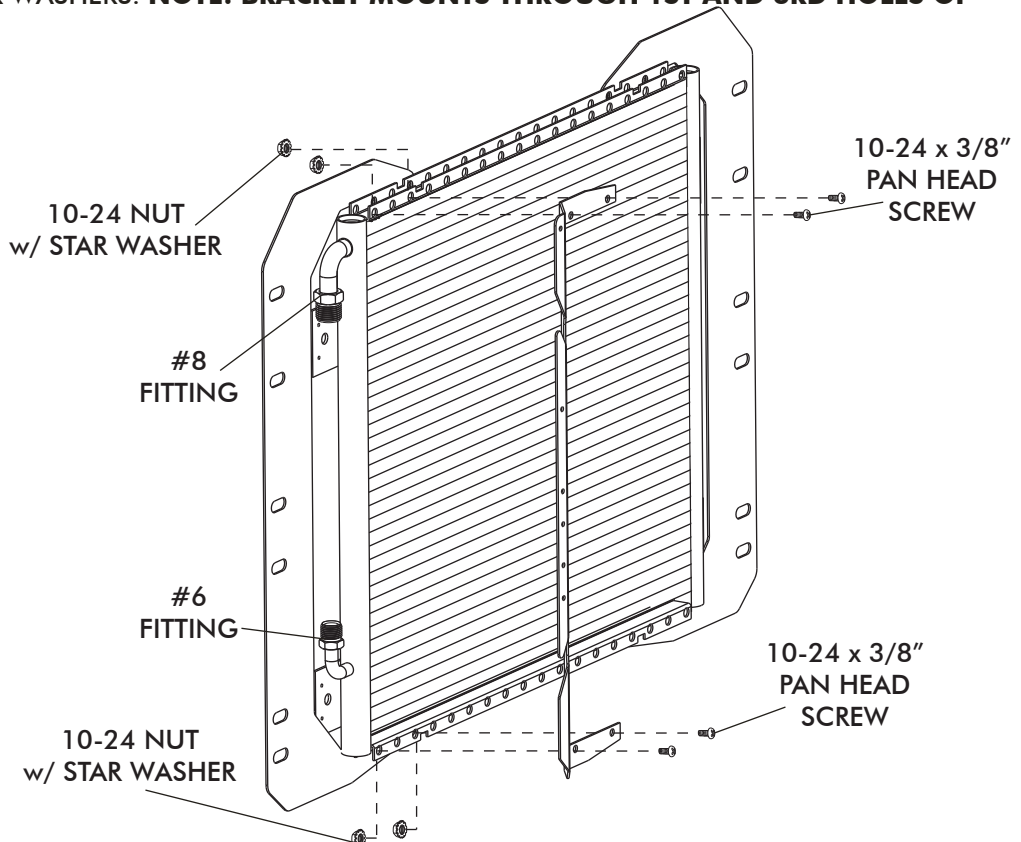



DRIER INSTALLATION

- INSTALL DRIER CLAMPS 07113-VUB.
- USING #10 x 1/2" SHEETMETAL SCREWS, INSTALL DRIER ON BRACKET IN THE 3RD AND 6TH HOLES FROM THE TOP AS SHOWN.

NOTE: REFRIGERANT FLOW THROUGH DRIER IS IN FROM CONDENSER, OUT TO EVAPORATOR.

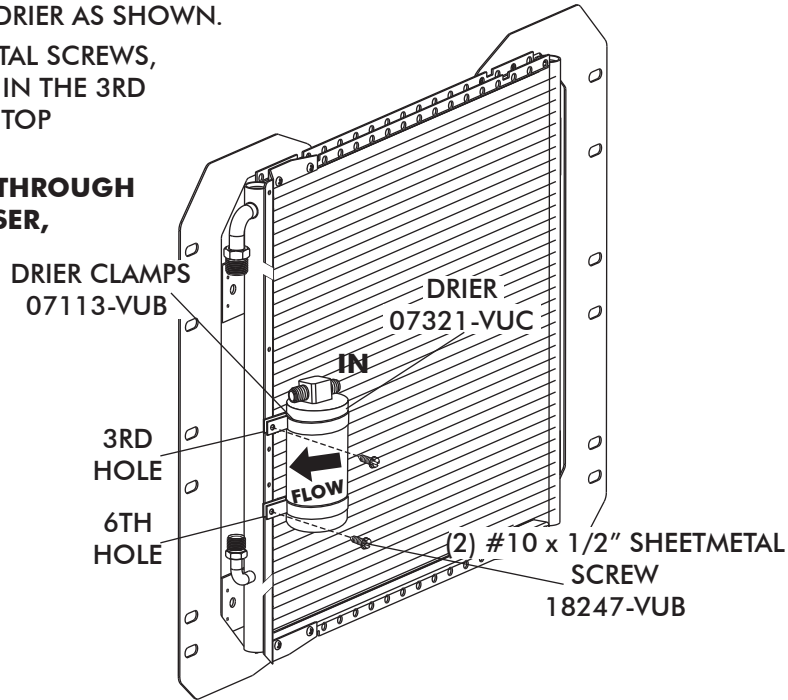

HARDLINE INSTALLATION

- LUBRICATE 2-#6 O-RINGS AND INSTALL THE #6 DRIER/CONDENSER HARDLINE AS SHOWN. TIGHTEN FITTINGS. SEE FIGURE 1. **(OIL SUPPLIED WITH HOSE KIT)**

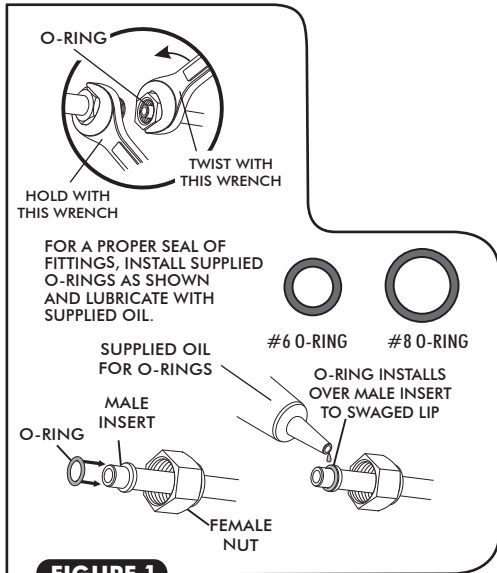
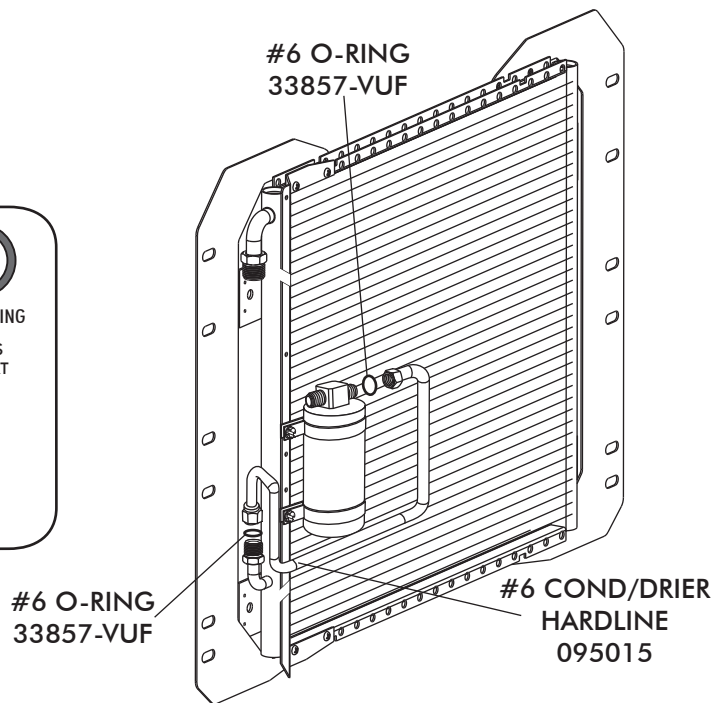

FIGURE 1





CONDENSER INSTALLATION

- INSTALL CONDENSER/DRIER ASSEMBLY BETWEEN RADIATOR AND ENGINE SIDE OF CORE SUPPORT USING OEM BOLTS AND OEM HOLES AS SHOWN. **NOTE: CONDENSER MOUNTS USING 2ND, 4TH, AND 6TH HOLES FROM TOP OF CONDENSER BRACKETS.**

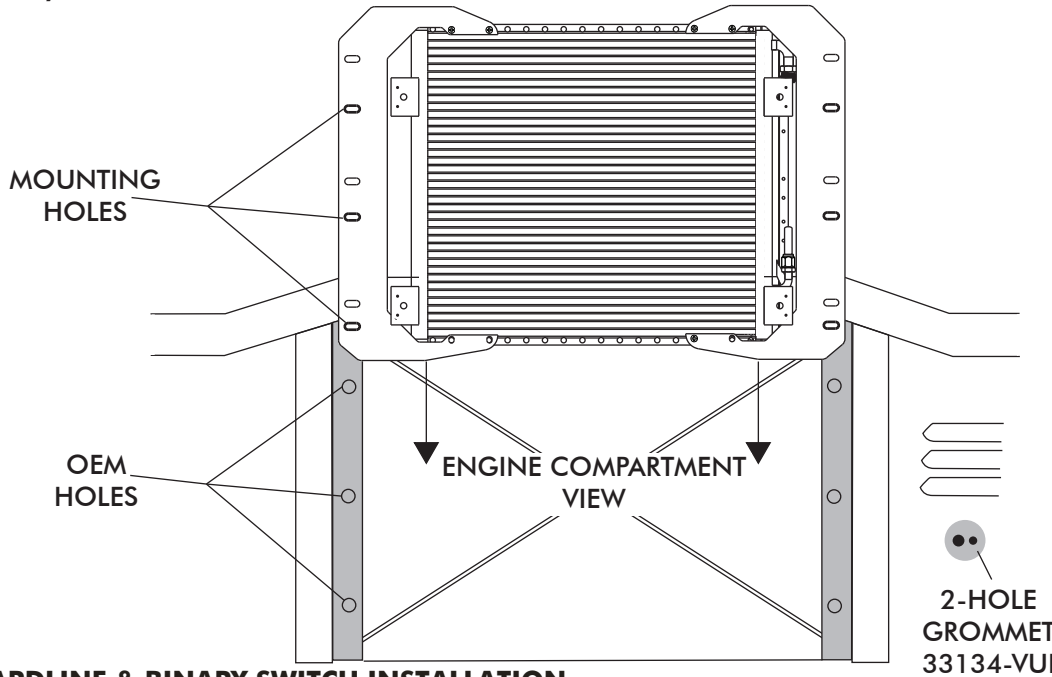

HARDLINE & BINARY SWITCH INSTALLATION

- LUBRICATE A #6 O-RING (SEE FIGURE 1 PAGE 6) AND INSTALL THE #6 HARDLINE. TIGHTEN FITTINGS AS SHOWN. **(OIL SUPPLIED IN HOSE KIT)**
- LUBRICATE A #8 O-RING AND INSTALL THE #8 HARDLINE AS SHOWN.
- INSTALL BINARY SWITCH.

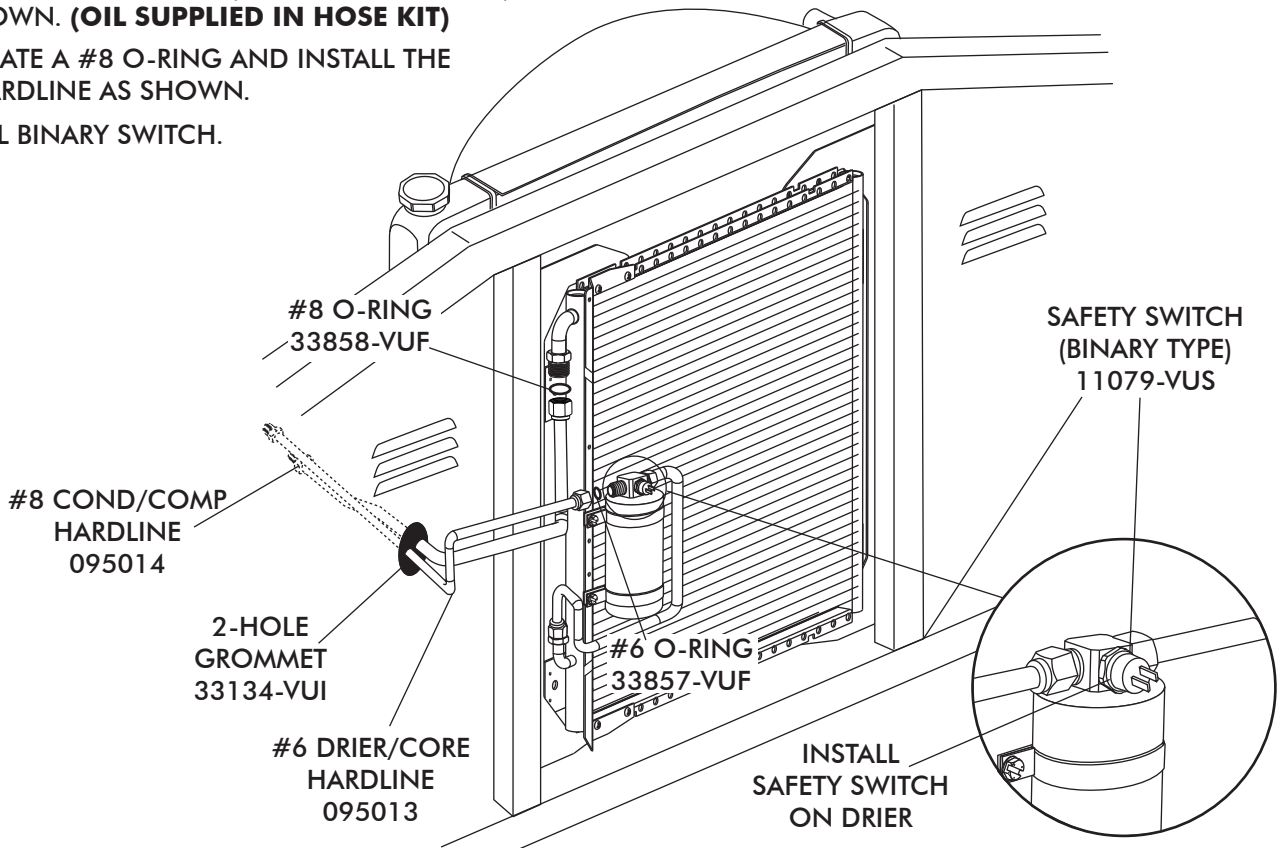



HARDLINE ADEL CLAMP INSTALLATION

- INSTALL ADEL CLAMPS ON HARDLINES AND SECURE TO INNER FENDER AS SHOWN BELOW.
- RE-INSTALL OEM RADIATOR, BATTERY TRAY, AND PASSENGER SIDE BAFFLE.

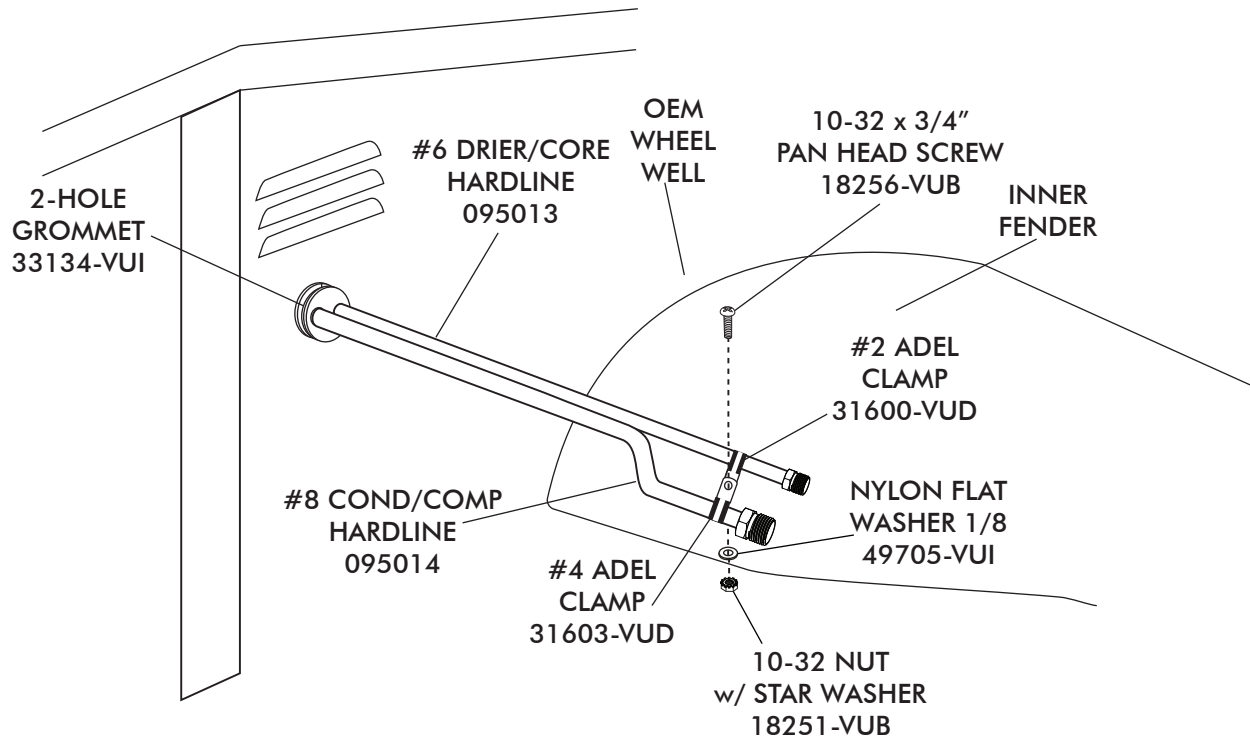



1960-66 CHEV PICK-UP CONDENSER WITH DRIER

CONDENSER KIT
021564

No.	QTY.	PART No.	DESCRIPTION
1.	1	03768-VUC	17" X 19" SUPER FLOW COND
2.	2	07113-VUB	DRIER CLAMP
3.	1	07321-VUC	DRIER
4.	2	18247-VUB	#10 x 1/2" HEX SCREW
5.	12	18249-VUB	10-24 X 3/8" PAN HEAD SCREW
6.	12	18260-VUB	10-24 NUT W/STAR WASHER
7.	1	33134-VUI	2 HOLE GROMMET
8.	3	33857-VUF	#6 O-RING
9.	1	33858-VUF	#8 O-RING
10.	1	095015	HARDLINE 60-66 CHEV P-UP #6 COND/DRIER
11.	1	095013	HARDLINE 60-66 CHEV P-UP #6 DRIER/CORE
12.	1	095014	HARDLINE 60-66 CHEV P-UP #8 COND/COMP
13.	2	644091	BRKT 55-66 CHEV P-UP COND
14.	1	644090	BRKT 55-66 CHEV P-UP DRIER
15.	1	31600-VUD	#2 ADEL CLAMP
16.	1	31603-VUD	#4 ADEL CLAMP
17.	1	11079-VUS	MALE BINARY SWITCH
18.	1	23135-VUW	COMPRESSOR LEAD
19.	1	18256-VUB	10-32 x 3/4 PAN HEAD SCREW
20.	1	49705-VUI	NYLON FLAT WASHER 1/8
21.	1	18251-VUB	10-32 NUT w/ STAR WASHER

CHECKED BY: _____
 PACKED BY: _____
 DATE: _____

