



an ISO 9001:2008 Registered Company

1967-72 CHEV PICK-UP

CONDENSER WITH DRIER

021567

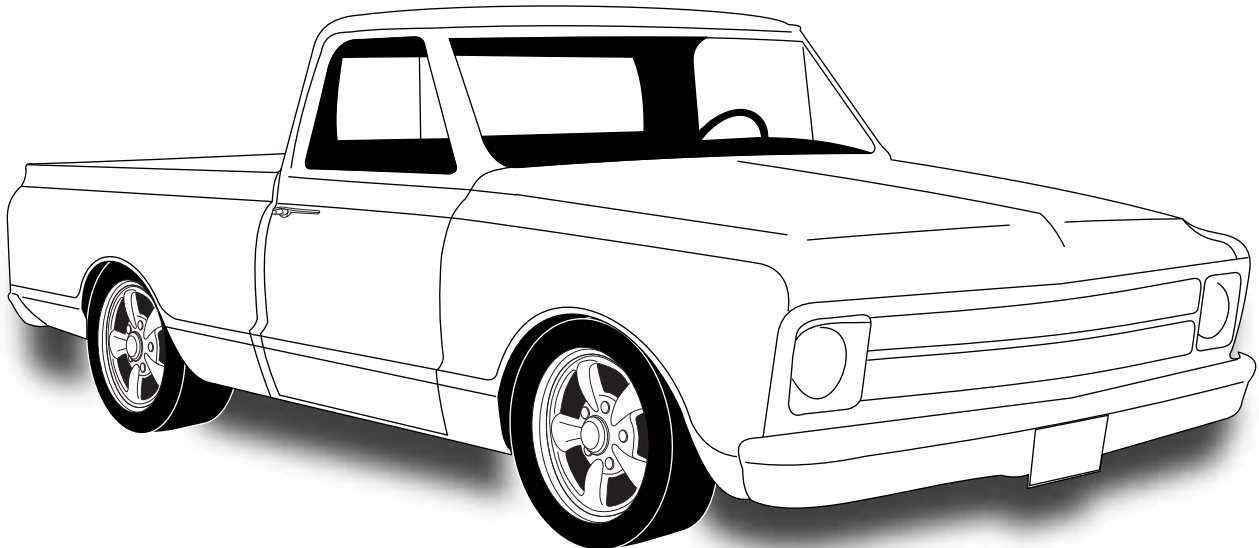

18865 GOLL ST. - SAN ANTONIO, TX. - 78266 ph.210-654-7171 - fax 210-654-3113



TABLE OF CONTENTS

PAGES

1. COVER
2. TABLE OF CONTENTS
3. PACKING LIST/PARTS DISCLAIMER
4. HOOD LATCH ASM. & CORE SUPPORT MODIFICATION
5. MOUNTING & DRIER BRACKET INSTALLATION
6. DRIER AND HARDLINE INSTALLATION
FIGURE 1
7. CONDENSER INSTALLATION
8. HARDLINE & BINARY SWITCH INSTALLATION / OEM HARDLINE CLAMP
9. HARDLINE BRACKET INSTALLATION (NON FACTORY AIR TRUCKS ONLY)
10. CORE SUPPORT MODIFICATION TEMPLATE
11. PACKING LIST



1967-72 CHEV PICK-UP CONDENSER WITH DRIER

CONDENSER KIT
021567

No.	QTY.	PART No.	DESCRIPTION
1.	1	03767-VUC	14" X 24" PARALLEL FLOW COND.
2.	2	07113-VUB	DRIER CLAMP
3.	1	07321-VUC	DRIER
4.	2	18101-VUB	10-32 WELL NUT
5.	2	18247-VUB	#10 x 1/2" HEX SCREW
6.	8	18249-VUB	10-24 X 3/8" PAN HEAD SCREW
7.	2	18253-VUB	10-32 X 1" PAN HEAD SCREW
8.	8	18260-VUB	10-24 NUT W/STAR WASHER
* 9.	1	18290-VUB	1/4-20 X 1" HEX BOLT
* 10.	1	18152-VUB	1/4-20 HEX NUT W/STAR WASHER
* 11.	2	18125-VUB	1/4" FLAT WASHER
* 12.	1	18258-VUB	10-32 X 3/4" PAN HEAD SCREW
* 13.	1	18251-VUB	10-32 NUT W/STAR WASHER
14.	1	33134-VUI	2 HOLE GROMMET
15.	3	33857-VUF	#6 O-RING
16.	1	33858-VUF	#8 O-RING
17.	1	35056-LCG	HARDLINE 67-72 CHEV P-UP #6 COND/DRIER
18.	1	095006	HARDLINE 67-72 CHEV P-UP #6 DRIER/CORE
19.	1	095007	HARDLINE 67-72 CHEV P-UP #8 COND/COMP
20.	1	644078	BRKT 67-72 CHEV P-UP TOP COND
21.	1	644079	BRKT 67-72 CHEV P-UP BOTTOM COND
* 22.	1	64770-VCB	SHEET METAL BRACKET
23.	1	65998-VUB	UNIVERSAL DRIER BRACKET
* 24.	1	31600-VUD	#2 ADEL CLAMP
* 25.	1	31603-VUD	#4 ADEL CLAMP
26.	1	11079-VUS	MALE BINARY SWITCH
27.	1	23135-VUW	COMPRESSOR LEAD

* - (FOR NON FACTORY AIR TRUCKS ONLY)

BEFORE BEGINNING INSTALLATION OPEN ALL PACKAGES AND CHECK CONTENTS OF SHIPMENT PLEASE REPORT ANY SHORTAGES DIRECTLY TO VINTAGE AIR WITHIN 15 DAYS. AFTER 15 DAYS, VINTAGE AIR WILL NOT BE RESPONSIBLE FOR MISSING OR DAMAGED ITEMS.

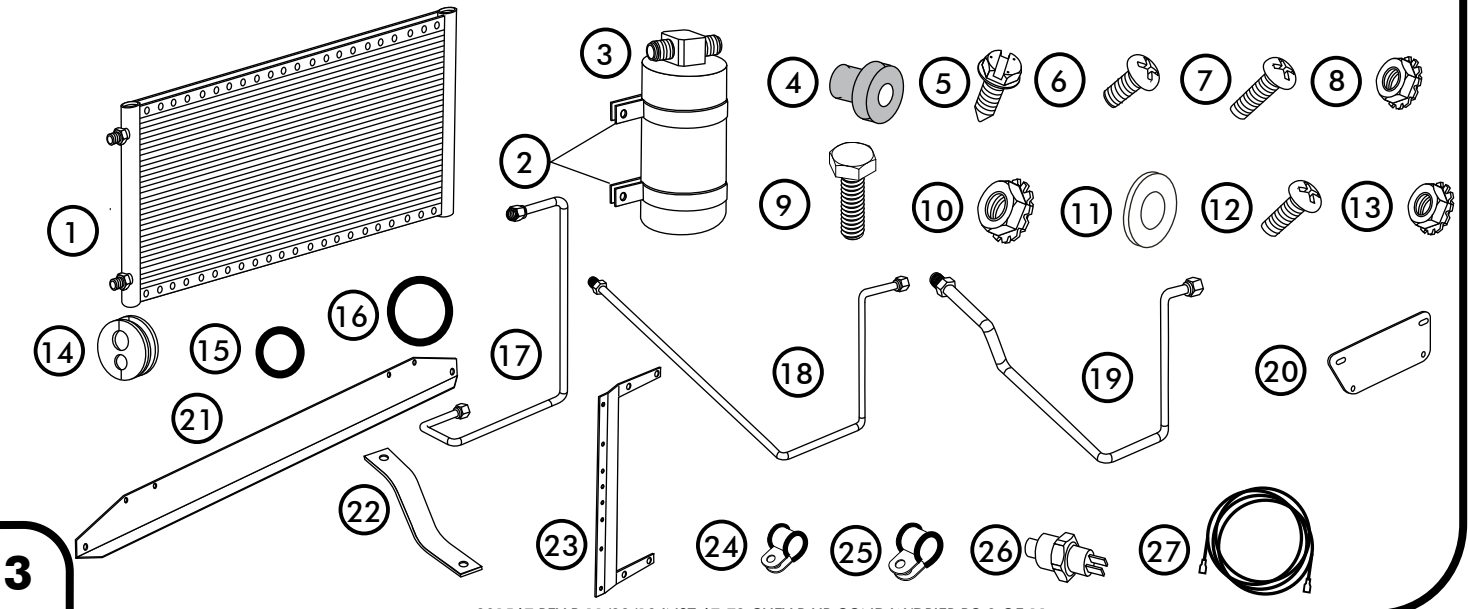



HOOD LATCH ASSEMBLY

- REMOVE OEM HOOD LATCH ASSEMBLY AS SHOWN.

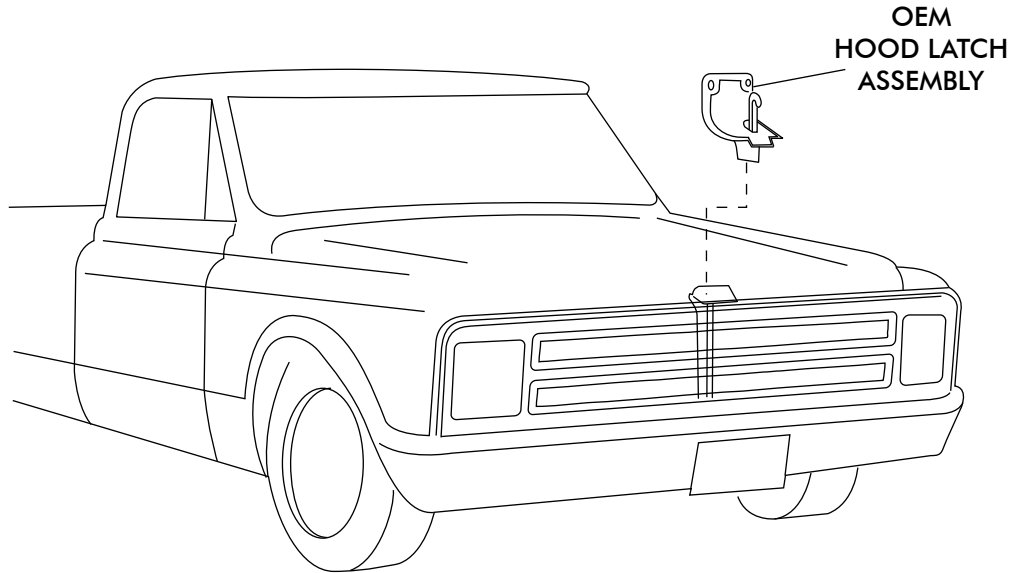

CORE SUPPORT MODIFICATION (FOR NON FACTORY AIR TRUCKS ONLY)

- NON FACTORY AIR TRUCKS USE OEM DIMPLES AS A GUIDE AND DRILL 1/4" PILOT HOLE OR USE TEMPLATE ON PAGE 10, AS SHOWN BELOW.
- DRILL 1 1/4" HOLE THROUGH BOTH PANELS.

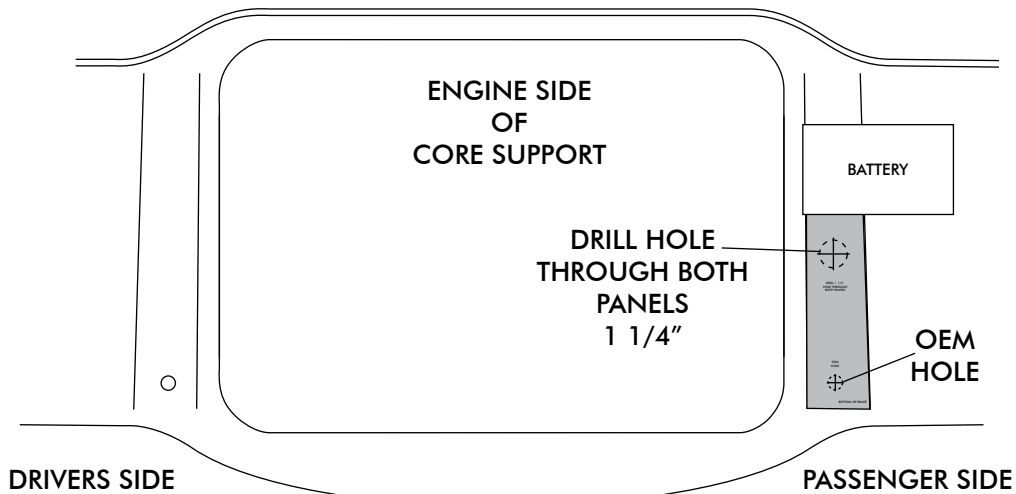



MOUNTING & DRIER BRACKET INSTALLATION

□ INSTALL TOP MOUNTING BRACKET ON TO CONDENSER USING 10-24 X 3/8" PAN HEAD SCREWS AND 10-24 NUTS WITH STAR WASHERS. **NOTE BRACKET MOUNTS THROUGH THE 8TH & 13TH HOLE FROM THE LEFT SIDE OF THE CONDENSER.**

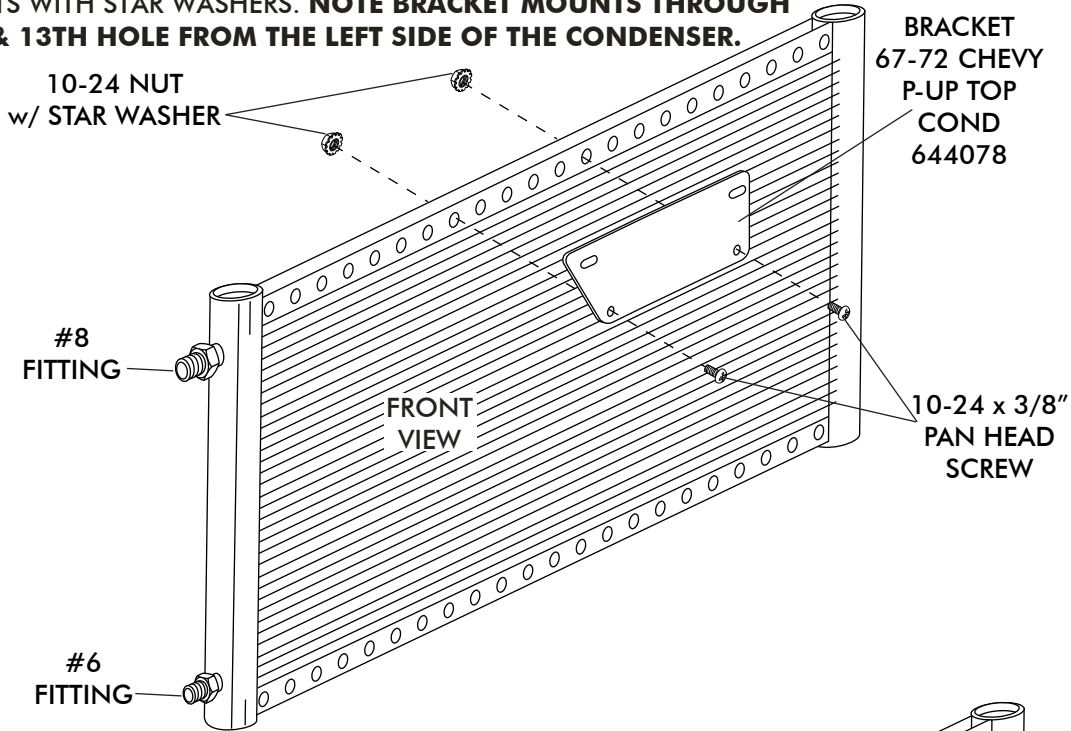

□ INSTALL BOTTOM MOUNTING BRACKET AND UNIVERSAL DRIER BRACKET ON TO CONDENSER USING 10-24 X 3/8" PAN HEAD SCREWS AND 10-24 NUTS WITH STAR WASHERS. **NOTE: BRACKET MOUNTS THROUGH 1ST AND 3RD HOLES FROM BOTH SIDES OF THE CONDENSER.**

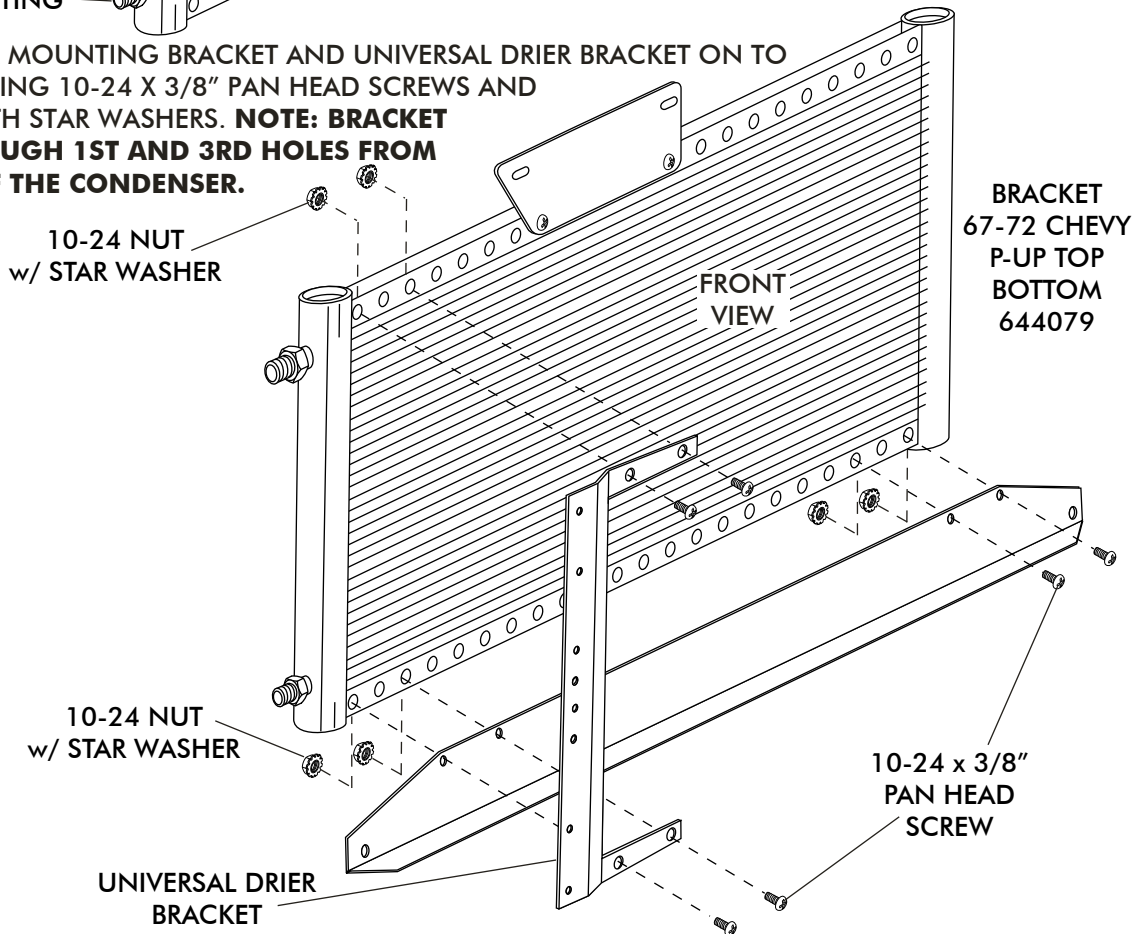



DRIER INSTALLATION

- INSTALL DRIER CLAMPS ON DRIER AS SHOWN.
- USING #10 x 1/2" SHEET METAL SCREWS, INSTALL DRIER ON BRACKET IN THE 2ND AND 4TH HOLES FROM THE TOP AS SHOWN. **NOTE: REFRIGERANT FLOW THROUGH DRIER IS IN FROM CONDENSER, OUT TO EVAPORATOR.**

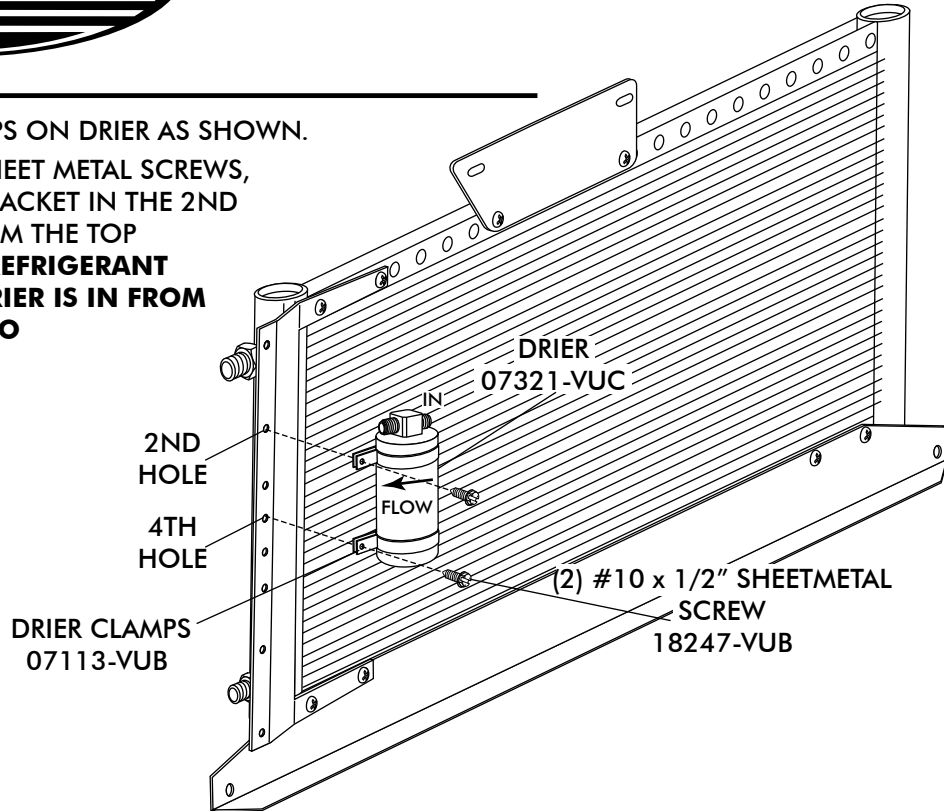

HARDLINE INSTALLATION

- LUBRICATE 2-#6 O-RINGS AND INSTALL THE #6 DRIER/CONDENSER HARDLINE AS SHOWN. TIGHTEN FITTINGS. SEE FIGURE 1.

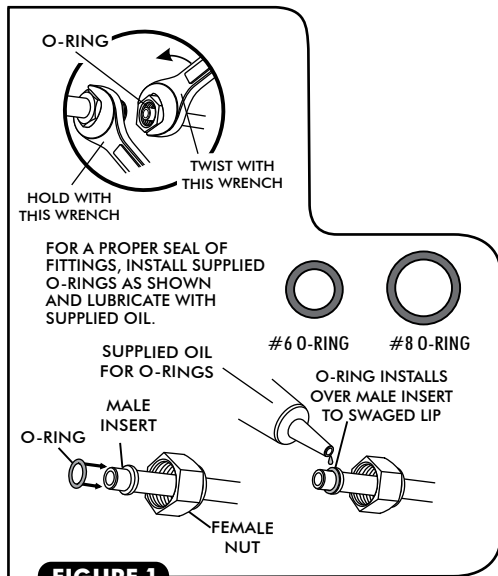
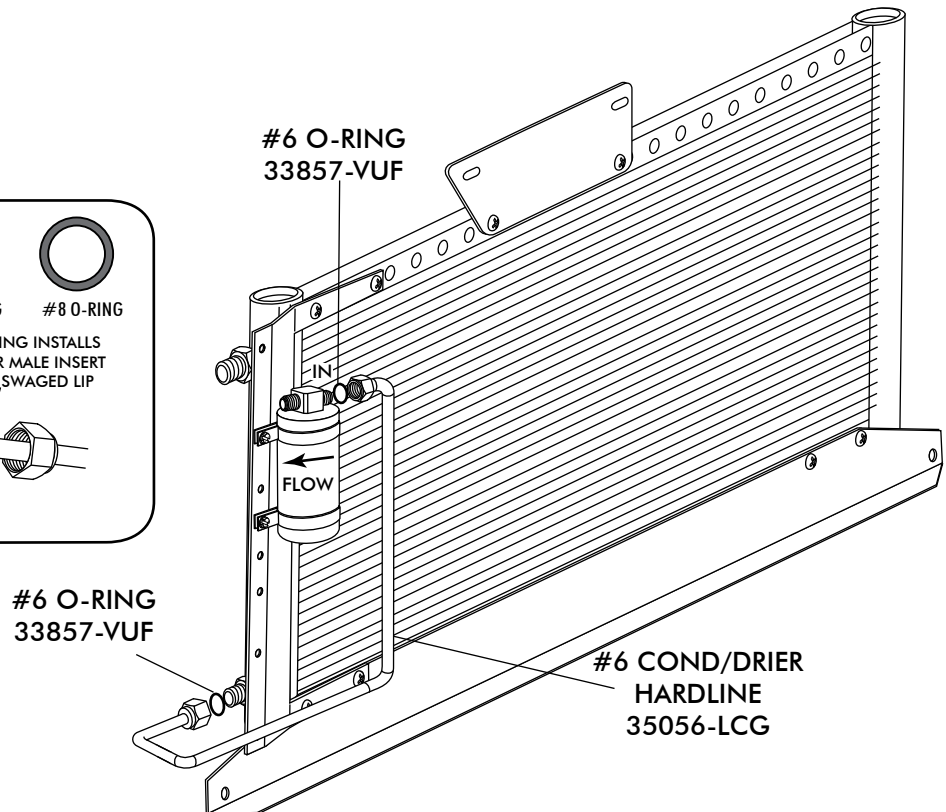

FIGURE 1





CONDENSER INSTALLATION

NOTE: NON FACTORY AC TRUCKS USE OEM DIMPLE AND DRILL 3/8" HOLE OR USE LOWER CONDENSER BRACKET AS TEMPLATE.

- INSTALL 10-32 WELL NUTS INTO OEM HOLES.
- INSTALL CONDENSER AS SHOWN BELOW. LOWER CONDENSER WITH HARDLINE & DRIER BETWEEN FRONT SIDE OF CORE SUPPORT AND GRILLE.

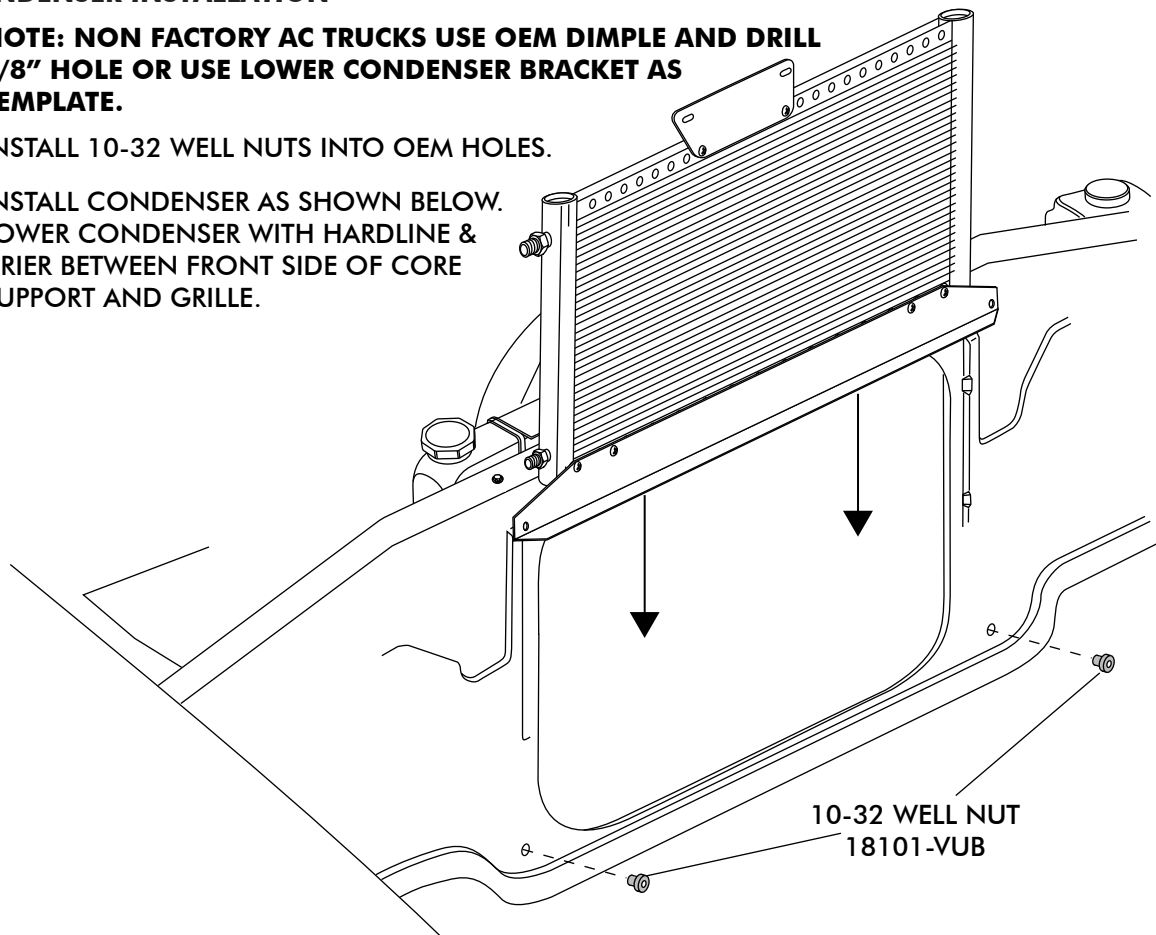

- USING OEM BOLTS RE-INSTALL HOOD LATCH ASSEMBLY. INSTALL OEM BOLTS THROUGH HOOD LATCH ASSEMBLY, CONDENSER BRACKET AND CORE SUPPORT.
- USING 10-32 X 1" PAN HEAD SCREWS, SECURE BOTTOM CONDENSER BRACKET TO CORE SUPPORT.

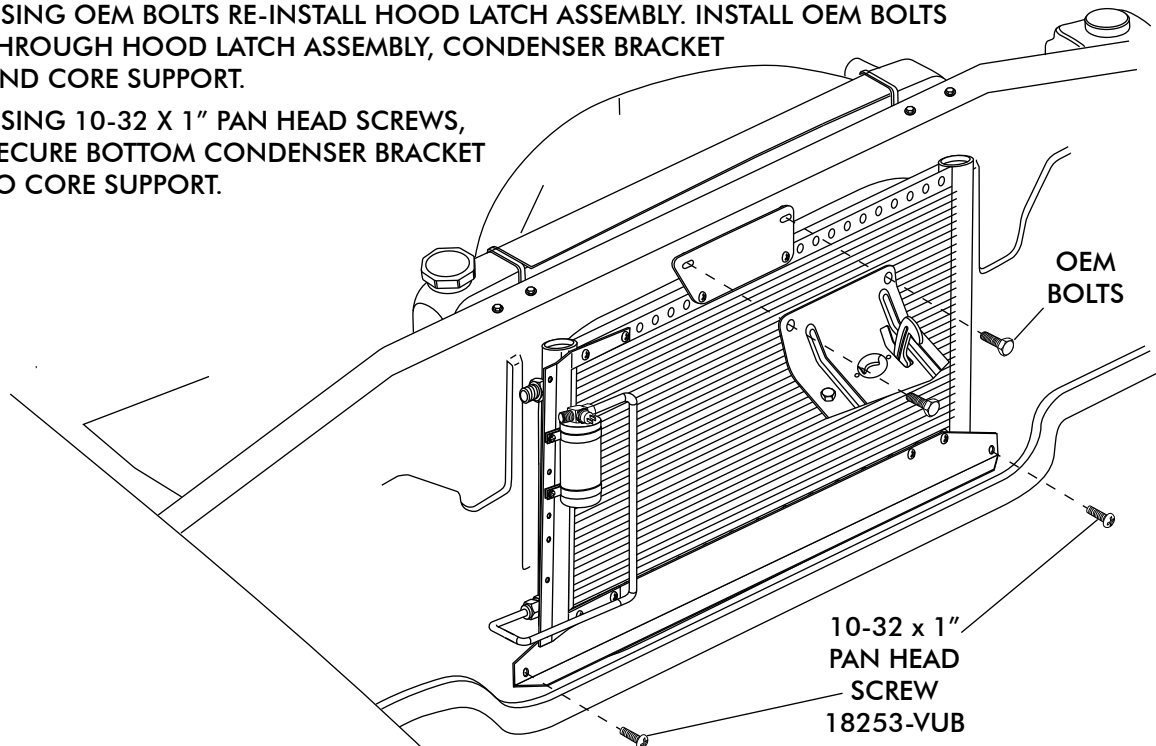



HARDLINE & BINARY SWITCH INSTALLATION

- INSTALL 2-HOLE GROMMET.
- LUBRICATE A #6 O-RING (SEE FIGURE 1 PAGE 6) AND INSTALL THE #6 HARDLINE. TIGHTEN FITTINGS AS SHOWN.
- LUBRICATE A #8 O-RING AND INSTALL THE #8 HARDLINE AS SHOWN.
- INSTALL BINARY SWITCH.

#8 COND/COMP HARDLINE 095007

#8 O-RING 33858-VUF

#6 DRIER/CORE HARDLINE 095006

2-HOLE GROMMET 33134-VUI

#6 O-RING 33857-VUF

SAFETY SWITCH (BINARY TYPE) 11079-VUS

INSTALL SAFETY SWITCH ON DRIER

OEM HARDLINE CLAMP (FACTORY AIR TRUCKS ONLY)

- SECURE LINES BETWEEN OEM SUPPORT AND OEM HARDLINE CLAMP USING OEM BOLT AS SHOWN.

2-HOLE GROMMET 33134-VUI

OEM BOLT

OEM BATTERY TRAY

#6 DRIER/CORE HARDLINE 095006

OEM SUPPORT

#8 COND/COMP HARDLINE 095007

OEM HARDLINE CLAMP



HARDLINE BRACKET INSTALLATION (NON FACTORY AIR TRUCKS ONLY)

- DRILL 9/32" HOLE IN OEM BATTERY TRAY AS SHOWN BELOW.
- SECURE SHEET METAL BRACKET TO OEM BATTERY TRAY USING A 1/4-20 X 1" HEX BOLT W/FLAT WASHERS AND 1/4-20 NUT W/STAR WASHER.
- INSTALL ADEL CLAMPS ON HARDLINES AS SHOWN BELOW.

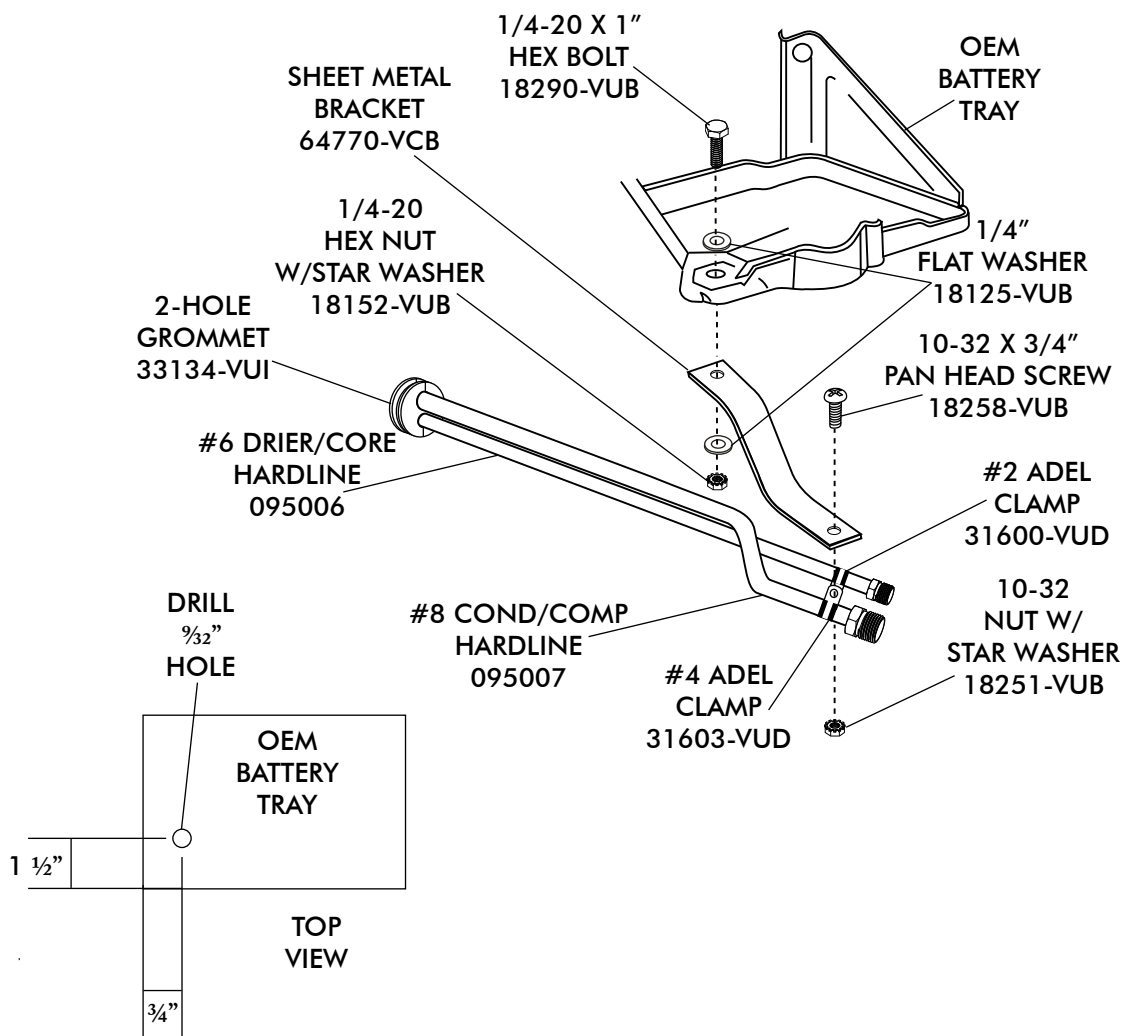

BATTERY SUPPORT
BRACE

ENGINE SIDE OF CORE
SUPPORT
67-72 CHEV/GMC PICK-UP

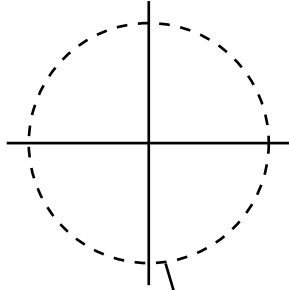

DRILL 1 1/4"
HOLE THROUGH
BOTH PANELS

**TEMPLATE FOR
NON FACTORY AIR
TRUCKS ONLY**

OEM
HOLE

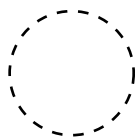

BOTTOM OF BRACE

FOLD ON LINE

FOLD ON LINE



1967-72 CHEV PICK-UP CONDENSER WITH DRIER

**CONDENSER KIT
021567**

No.	QTY.	PART No.	DESCRIPTION
1.	1	03767-VUC	14" X 24" PARALLEL FLOW COND.
2.	2	07113-VUB	DRIER CLAMP
3.	1	07321-VUC	DRIER
4.	2	18101-VUB	10-32 WELL NUT
5.	2	18247-VUB	#10 x 1/2" HEX SCREW
6.	8	18249-VUB	10-24 X 3/8" PAN HEAD SCREW
7.	2	18253-VUB	10-32 X 1" PAN HEAD SCREW
8.	8	18260-VUB	10-24 NUT W/STAR WASHER
* 9.	1	18290-VUB	1/4-20 X 1" HEX BOLT *
* 10.	1	18152-VUB	1/4-20 HEX NUT W/STAR WASHER *
* 11.	2	18125-VUB	1/4" FLAT WASHER *
* 12.	1	18258-VUB	10-32 X 3/4" PAN HEAD SCREW *
* 13.	1	18251-VUB	10-32 NUT W/STAR WASHER *
14.	1	33134-VUI	2 HOLE GROMMET
15.	3	33857-VUF	#6 O-RING
16.	1	33858-VUF	#8 O-RING
17.	1	35056-LCG	HARDLINE 67-72 CHEV P-UP #6 COND/DRIER
18.	1	095006	HARDLINE 67-72 CHEV P-UP #6 DRIER/CORE
19.	1	095007	HARDLINE 67-72 CHEV P-UP #8 COND/COMP
20.	1	644078	BRKT 67-72 CHEV P-UP TOP COND
21.	1	644079	BRKT 67-72 CHEV P-UP BOTTOM COND
* 22.	1	64770-VCB	SHEET METAL BRACKET *
23.	1	65998-VUB	UNIVERSAL DRIER BRACKET
* 24.	1	31600-VUD	#2 ADEL CLAMP *
* 25.	1	31603-VUD	#4 ADEL CLAMP *
26.	1	11079-VUS	MALE BINARY SWITCH
27.	1	23135-VUW	COMPRESSOR LEAD

*** - (FOR NON FACTORY AIR TRUCKS ONLY)**

CHECKED BY: _____
 PACKED BY: _____
 DATE: _____

